

# LIMIT SWITCH

## WJL-L5

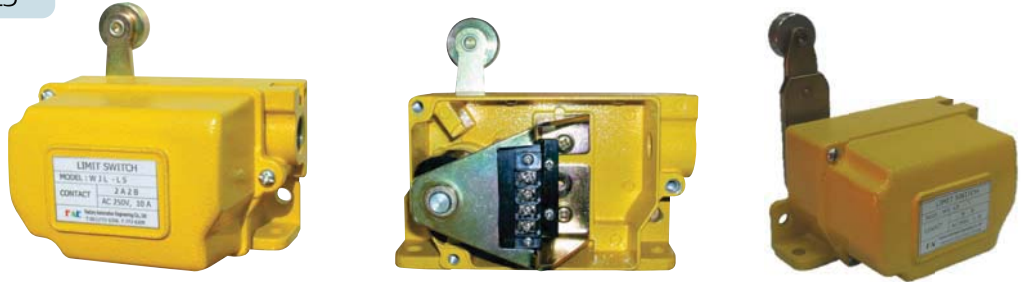

### ◆ 개요 및 특징(Introduction & Feature)

- 자동복귀형  
Auto-Return Type
- Lever 작동시 Return Spring에 의해 작동 복귀되는 장치입니다.  
This is a device that lever is Automatically returned by return spring,
- IP65

### ◆ 표준사양(Standard Specification)

MODEL	WJL - L5
접점구성 (Contacts Composition)	비접촉 방식(Non-Contacting) : SPSTx2(2A,1A1B,2B) 접촉방식(Contact method) : SPDTx2(2C/O)
접점용량 (Contacts Capacity)	비접촉 방식(Non-Contacting) : 250VAC, 1A / 200VDC, 1.5A 접촉방식(Contact method) : 250VAC, 10A / 250VDC, 0.3A
케이블 인입구 (Cable Entry)	PF1/2"
사용주위온도 (Optimal Temperature)	-20°C ~ +80°C
색 상 (Color)	하마톤 IPH 노랑(Hammertion IPH Yellow) (EX8816-YW002)

### ◆ 제품선정 (Product selection)

WJL - L5 - 22 - 01

- 01 : Short Lever
- 02 : Long Lever
- 03 : Adjust Lever

접점구성  
(Contacts Composition)

- L5 - 일반형  
Standard Type
- L5H - 고온형(80°C)  
High Temp. Type (80°C)

접점구성  
(Contacts Composition)

- 비접촉방식 : 11⇒1A1B  
(Non-Contact Method) 20⇒2A  
02⇒2B

접촉방식 : 22⇒2C/O  
(Contact type)

### ◆ 외형도(Outline Dimension)

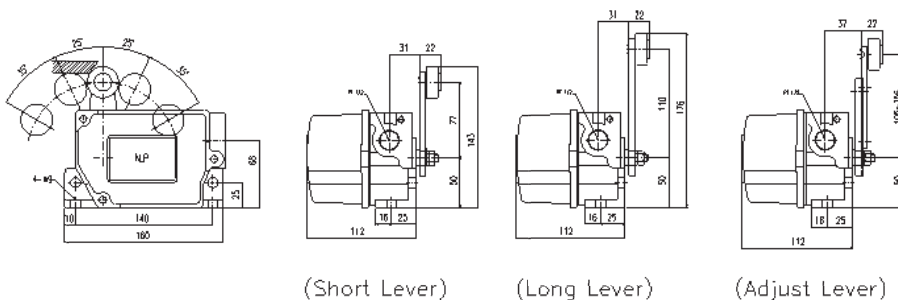

(Short Lever)

(Long Lever)

(Adjust Lever)

WJL-L6



WJL-PI



◆ 개요 및 특징(Introduction & Feature)

- 자동복귀형  
Manual Return Type
- Lever 작동시 Return Spring에 의해 작동 복귀되는 장치입니다.  
This is a device that lever is held on at operating position by interlock function.
- IP65

◆ 표준 사양(Standard Specification)

MODEL	WJL-L6 / WJL - PI
접점구성 (Contacts Composition)	비접촉 방식(Non-Contacting) : SPSTx2(2A,1A1B,2B) 접촉방식(Contact method) : SPDTx2(2C/O)
접점용량 (Contacts Capacity)	비접촉 방식(Non-Contacting) : 250VAC, 1A / 200VDC, 1.5A 접촉방식(Contact method) : 250VAC, 10A / 250VDC, 0.3A
케이블 인입구 (Cable Entry)	PF1/2"
사용주위온도 (Optimal Temperature)	-20°C ~ +80°C
색 상 (Color)	하마톤 IPH 노랑(Hammertion IPH Yellow) (EX8816-YW002)

◆ 제품선정 (Order Information)

WJL - L6 - 2 2

접점구성  
(Contacts Composition)

L6 - 일반형  
STANDARD Type

L6H - 고온형 (80°C)  
High Temp.Type(80°C)

PI - 일반형  
STANDARD Type

PIH - 고온형 (80°C)  
High Temp.Type(80°C)

접점구성  
(Contacts Composition)

비접촉방식 : 11⇒1A1B  
(Non-Contact Method) 20⇒2A

접촉 방식 : 22⇒2C/O  
(Contact type)

◆ 외형도(Outline Dimension)

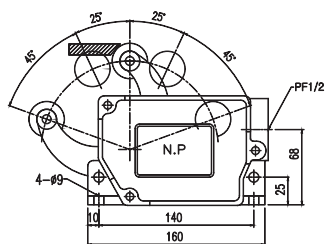

(WJL-L6)

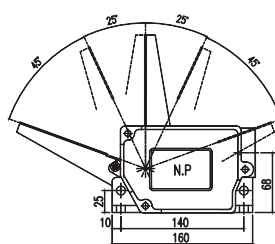

(WJL-PI)