

CONVEYOR BELT SAFETY SWITCH & INDUSTRY SWITCH

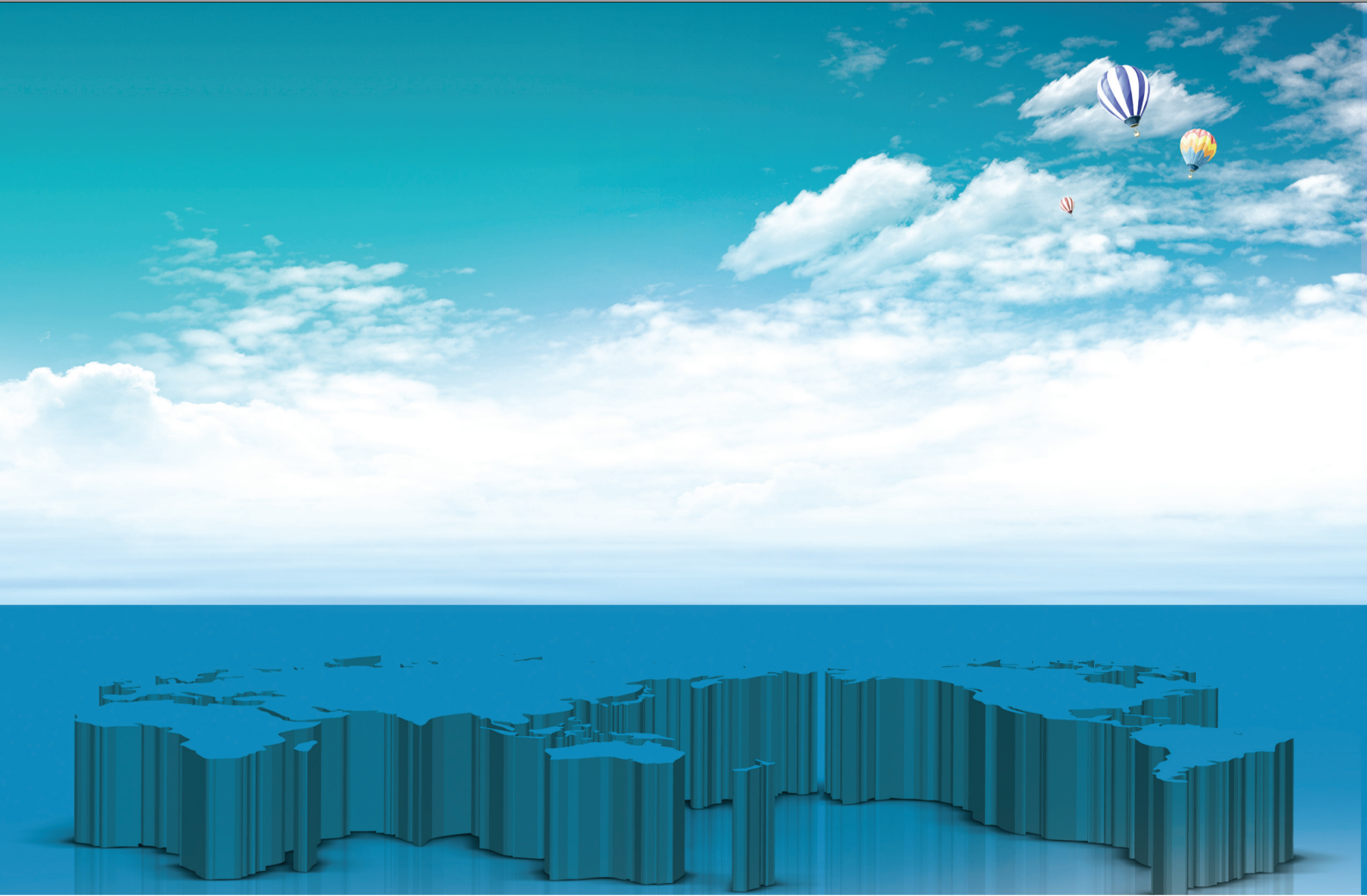



공장자동화 산업용 센서를 기반으로 엔지니어링 기업으로의 도약
COMPANY INTRODUCTION
Make Your Dream with FAE Company

당사의 사업분야는 컨베이어벨트 관련한 안전스위치를 비롯해서, 호퍼 레벨, 벨트 스케일 및 제어장치용 판넬 및 특수장치 등의 제품을 제작하고 있으며 공장 자동화, 무인화 시스템을 설계에서 시공까지 다양한 기술력을 주축으로 담당하게 세계시장에서 기술로써 승부하고자 합니다.

"고객감동, 창의, 프로정신"이라는 경영철학아래 꾸준히 연구하고 개발하여 제품발전에 한 발 더 앞서나가는 **주식회사 에프에이이**가 되겠습니다.
앞으로도 많은 관심을 부탁드립니다.

(주)에프에이이는 고객의 행복을 최고의 가치로 새로운 대한민국을 이끌어 나가겠습니다.

FAE (주)에프에이이
Factory Automation Engineering
www.pro-fae.co.kr

Factory Automation
Engineering Co.,Ltd



FAE (주)에프에이이
Factory Automation Engineering
www.pro-fae.co.kr

Factory Automation
Engineering Co.,Ltd



CONTENTS

1 CONVEYOR BELT SAFETY SWITCH

- PULL CORD SWITCH / 4
- BELT SWAY SWITCH / 10
- RIP SWITCH / 15
- SPEED SWITCH & CONTROLLER / 17
- TILT SWITCH / 21
- FLOW SWITCH / 24
- ACCESSORY / 26

2 WARNING LIGHT WITH SIREN

- 일반형 경광등 (Warning Horn & Light) / 28
- 방폭형 경광등 (EX Warning Horn & Light) / 30

3 중공업 리미트스위치

- 중부하 리미트스위치 (Heavy Duty Limit Switch) / 34
- 마그네트 스위치 (Magnet Switch) / 37

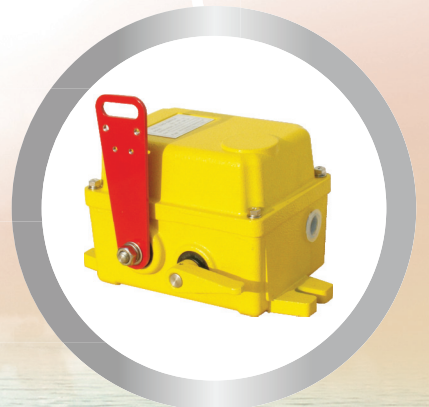
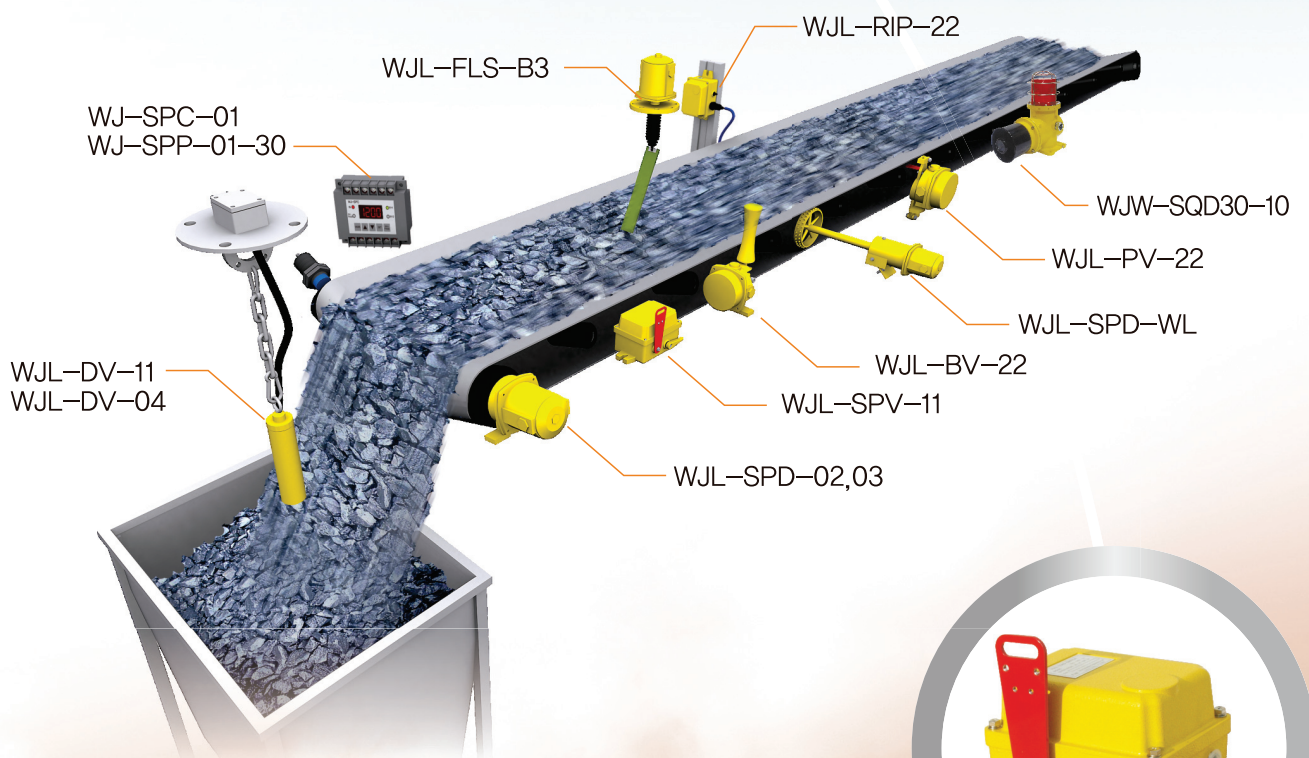

PULL CORD SWITCH

컨베이어벨트 작동 중 비상시에 와이어로프를 당겨 정지시키는 스위치입니다.

Pull Cord Switch is a switch that pulls wire rope to stop in emergency when working conveyor belt.

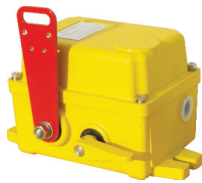

사각형
(Square Type)



일반형
(Standard Type)



램프형
(Lamp Type)



스프링내장형
(Spring embedded Type)

◆ 특징(Features)

- 비상시에 중단시킬 수 있으며 양방향 제어가 가능합니다.
It can work in both directions and stop in emergency.
- 알루미늄 다이캐스팅 제품으로 옥외 방수구조로 IP66입니다.
It is aluminum die casting product and outdoor waterproof structure IP66.
- 로프는 최대 50m까지 가능합니다.
Rope is available up to 50m.
- 비접촉방식의 접점채용.
Adopt Non-Contacting
- 스프링 내장으로 제품 수명 연장.(사각형, 스프링내장형)
Product life extended with built-in spring. (square type, spring embedded type)
- 사각형 구조로 정비성이 탁월하다.
Maintenance is great with square structure.

◆ 기본사양(Specification)

운전방식(Operation)	수동 복귀형(Manual Return Type)
접점구성 (Contacts Composition)	비접촉 방식(Non-Contacting) : SPSTx2(2A,1A1B,2B) 접촉방식(Contact method) : SPDTx2(2C/O)
접점용량 (Contacts Capacity)	비접촉 방식(Non-Contacting) : 250VAC, 1A / 200VDC, 1.5A 접촉방식(Contact method) : 250VAC, 10A / 250VDC, 0.3A
사용전원(Power)	DC24V, DC48V, AC110V, AC220V
케이블 인입구 (Cable Entry)	PF3/4" 표준(Standard)(PF1/2)
적정온도 (Optimal Temperature)	-20℃ ~ +80℃
색 상 (Color)	하마톤 IPH 노랑(Hammerion IPH Yellow) (EX8816-YW002)

◆ 결선도(Connection)

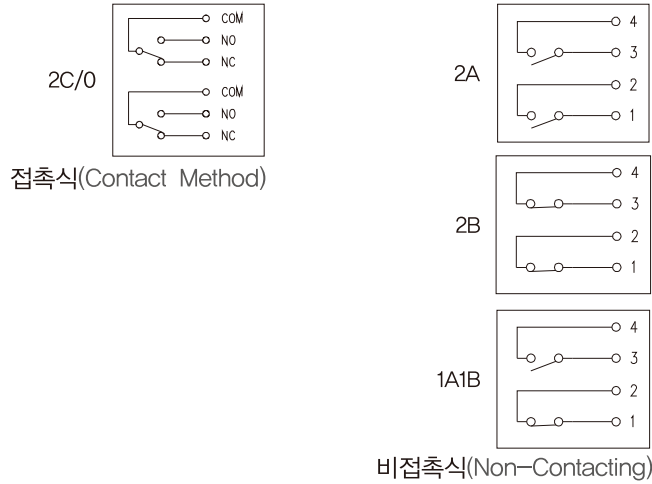

◆ 동작각도(Operation Angle)

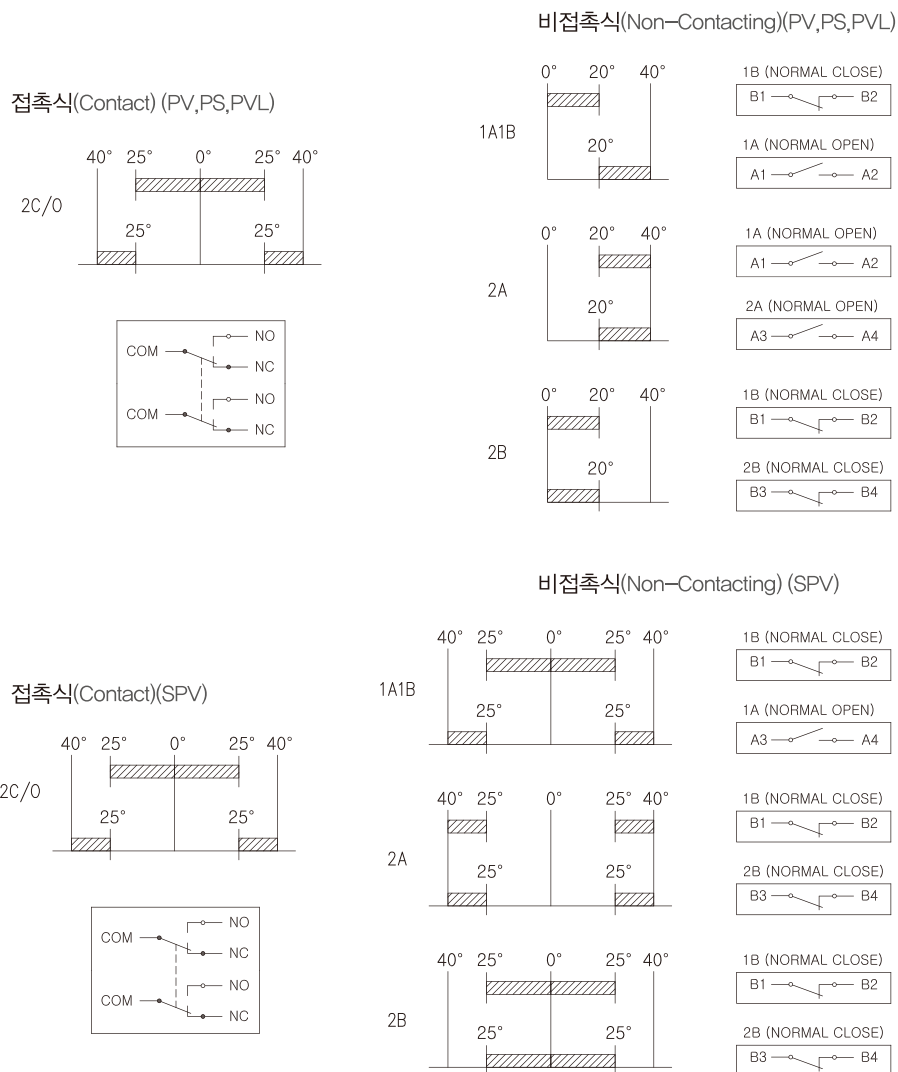

CONVEYOR BELT SAFETY SWITCH

◆ 외형도(Outline Dimension)

형식(Type)	사진(Photo)	외형도(Outline Dimension)
<p>WJL - SPV</p> <ul style="list-style-type: none"> - 비접촉 및 접촉식 (Non-contact & Contact type) - 스프링 내장형 (In-built spring) - 1A1B, 2A, 2B - 2C/O - 정비성향상 (Improved maintenance) - 중량(Mass) : 1.90Kg 		
<p>WJL - PV</p> <ul style="list-style-type: none"> - 비접촉 및 접촉식 (Non-contact & Contact type) - 1A1B, 2A, 2B - 2C/O - 중량(Mass) : 2.52KG 		
<p>WJL - PS</p> <ul style="list-style-type: none"> - 스프링 내장형 (In-built spring) - 비접촉 및 접촉식 (Non-contact & contact type) - 1A1B, 2A, 2B - 2C/O - 중량(Mass) : 2.72KG 		
<p>WJL - PVL</p> <ul style="list-style-type: none"> - LED LAMP형 (LED LAMP type) - 비접촉 및 접촉식 (Non-contact & contact type) - 1A1B, 2B - 2C/O - 중량(Mass) : 2.52KG 		

◆ 동작(Operation)

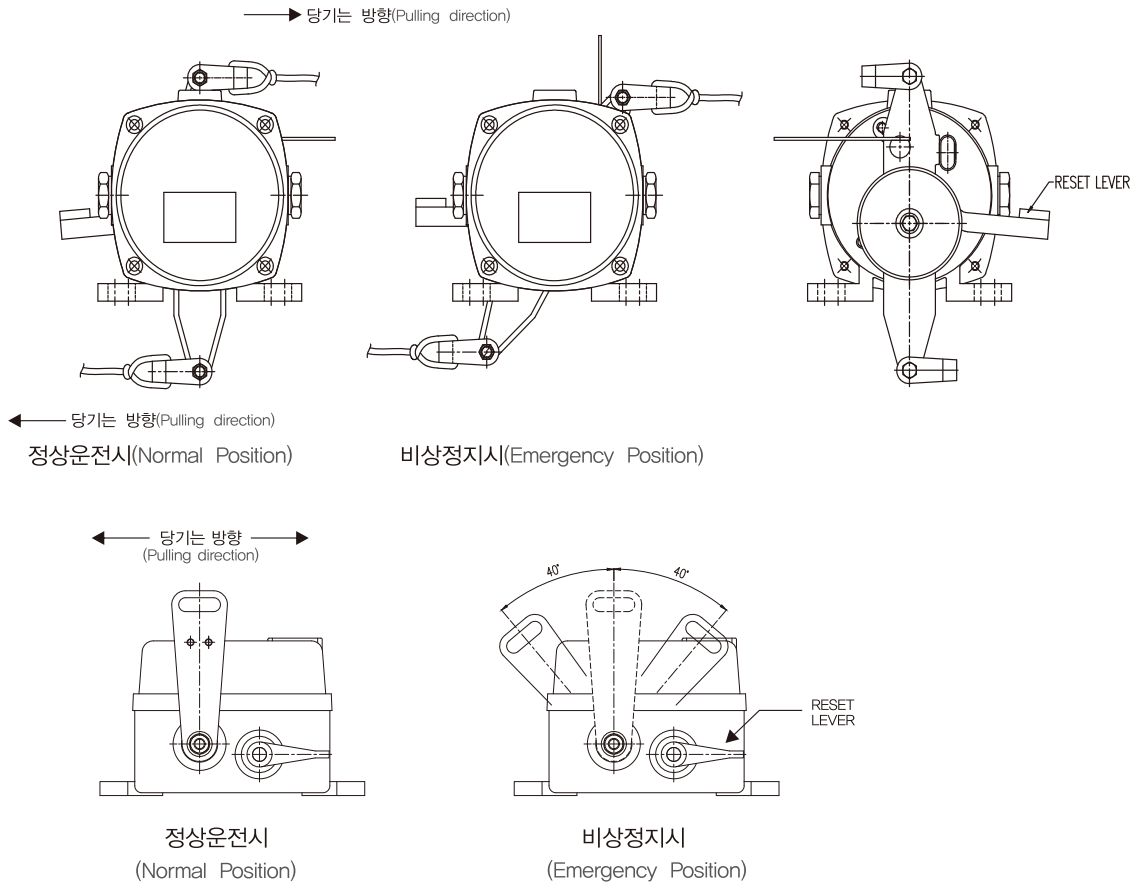

◆ 제품선정(Product Selection)

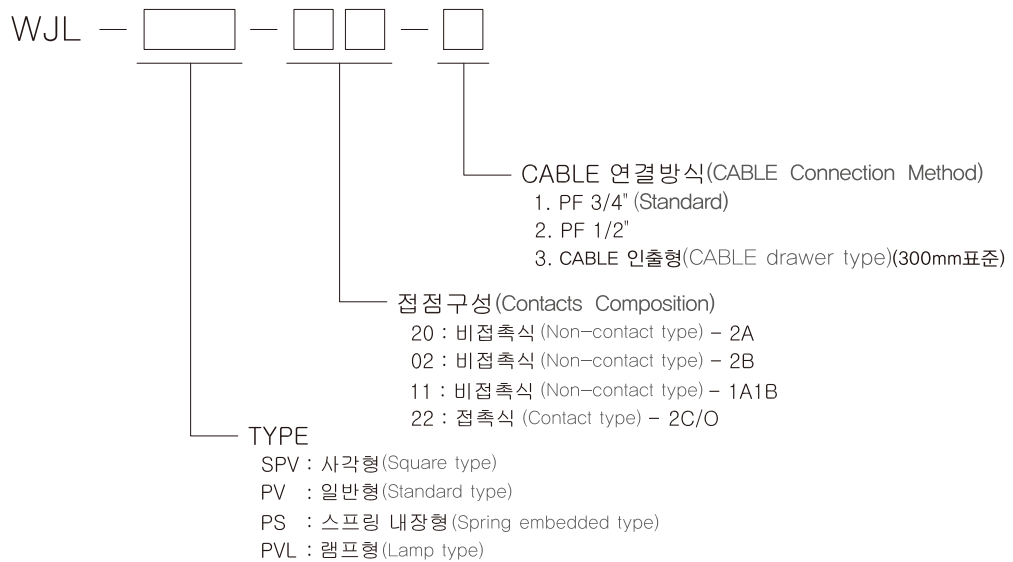

CONVEYOR BELT SAFETY SWITCH

EXPLOSION PROOF PULL CORD SWITCH (EX tD A22 IP66 / EX d 2G/D II C IP66)



콘베이어벨트 작동중 비상시에 와이어로프를 당겨 정지시키는 장치입니다.

Pull Cord Switch is a switch that pulls wire rope to stop in emergency when working conveyor belt.

◆ 특징(Features)

- 알루미늄 다이캐스팅 제품으로 경량이며, 기계적강도가 우수함.
Is light weight aluminum die casting product and Excellence in strength of mechanical,
- 스위치 및 캠이 더블스프링에 의한 2단장력으로 동작.
Switch and cam are action by 2 stage double spring
- 기계적진동 및 충격으로 흡수력이 뛰어남.
Absorption force is excellent by mechanical vibration,
- 로프는 최대 50M까지 가능합니다.
Rope is possible to up to 50 M
- 기술인증(Certification) : KTL, ATEX
- 보호등급(Protection CLASS) : KTL - EX tD A22 IP66 T85°C
ATEX - EX d 2G/D IIC IP66



◆ 기본사양(Specification)

MODEL	WJL-PV-22EX
접점구성 (Contacts Composition)	SPDTx2(2C/0)
접점용량 (Contacts Capacity)	250VAC, 10A / 250VDC 0,3A
케이블 인입구 (Cable Entry)	PF3/4" 표준(Standard) (PF1/2)
적정온도 (Optimal Temperature)	-20°C ~ +80°C
IP등급(IP grade)	IP66
색 상 (Color)	하마톤 IPH 노랑(Hammerton IPH Yellow) (EX8816-YW002)

◆ 결선도(Connection)

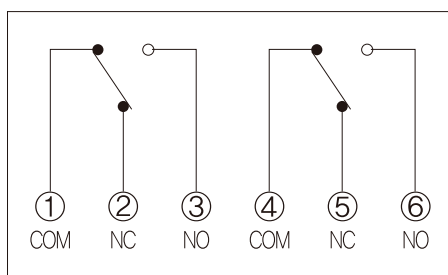

2C/0

◆ 동작(Operation)

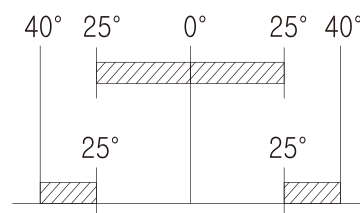

2C/0

◆ 동작(Operation)

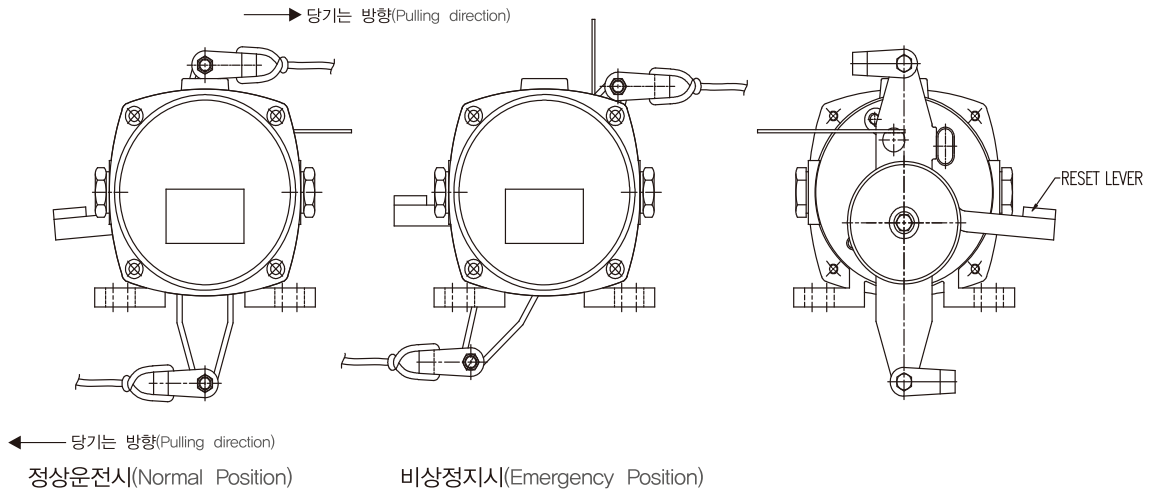

◆ 외형도(Outline Dimension)

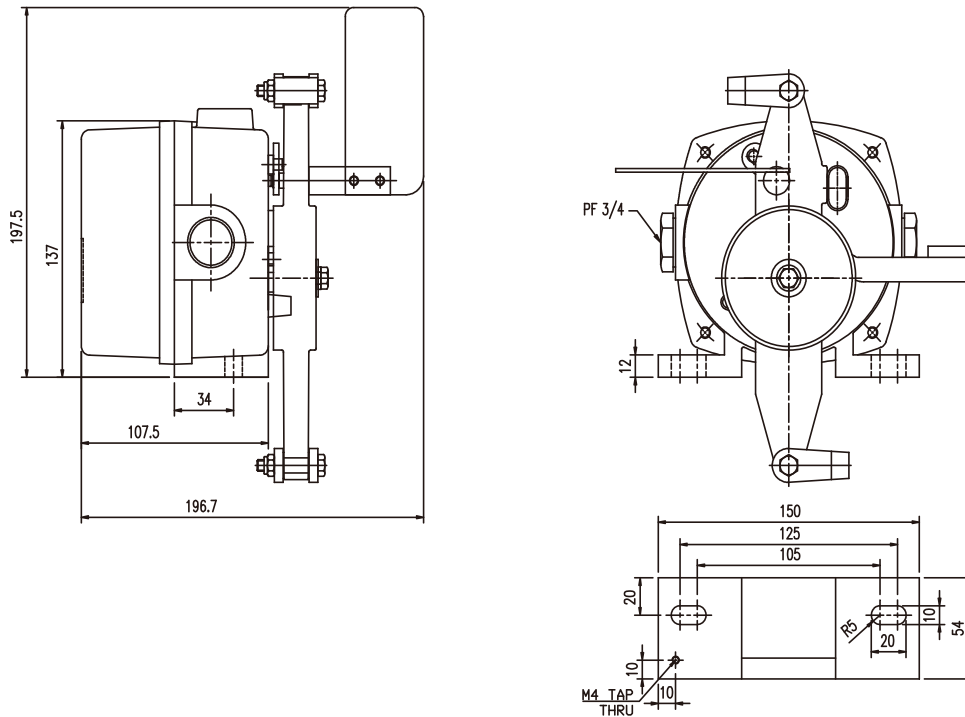

CONVEYOR BELT SAFETY SWITCH



BELT SWAY SWITCH

콘베어벨트 작동 중에 벨트가 한쪽으로 쓸림현상을 감지하는 장치입니다.

Belt Sway Switch is a device that perceives belt strain effect to one side when working conveyor belt.

◆ 특징(Features)

- 알루미늄 다이캐스팅 제품으로 방수,방진에 우수하다
Aluminum die casting product and excellence in water proof and vibration proof
- 비접촉방식의 접점채용
Adopt Non-Contacting
- 경보 및 제어를 동시에 할 수 있도록 2개 출력
2 Outputs for alarm and control at the same time
- 접촉 롤러가 라운드형태로 벨트 접촉이 원활하다
Contact roller is a round type and smoothes to contact belt,
- 터미널박스가 벨트 밖으로 되어 정비성 향상 및 작업시 안전성 확보(WJL-SBV)
Improved Maintenance and ensured secure because of out-situated terminal box (WJL-SBV)



◆ 기본사양(Specification)

운전방식(Operation)	수동 복귀형(Manual Return Type)	WJL-SBV
접점구성 (Contacts Composition)	비접촉 방식(Non-Contacting) : SPSTx2(2A,1A1B,2B) 접촉방식(Contact method) : SPDTx2(2C/O)	SPDTx2(2C/O)
접점용량 (Contacts Capacity)	비접촉 방식(Non-Contacting) : 250VAC, 1A / 200VDC, 1.5A 접촉방식(Contact method) : 250VAC, 10A / 250VDC, 0.3A	250VAC, 10A 250VDC, 0.3A
케이블 인입구 (Cable Entry)	PF3/4" Standard (PF1/2")	
적정온도 (Optimal Temperature)	-20°C ~ +80°C	
색 상 (Color)	하마톤 IPH 노랑(Hammertion IPH Yellow) (EX8816-YW002)	

◆ 결선도(Connection)

접촉식(Contact Method)

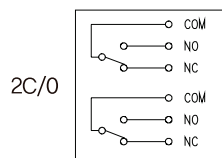

비접촉식(Non-Contact Method)

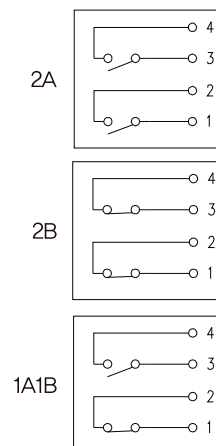

◆ 동작 각도(Operation Angle)

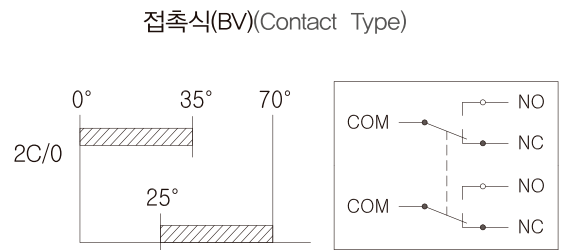
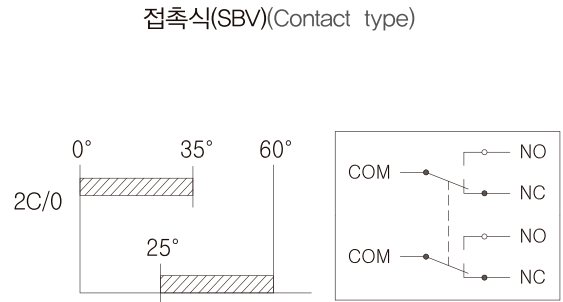
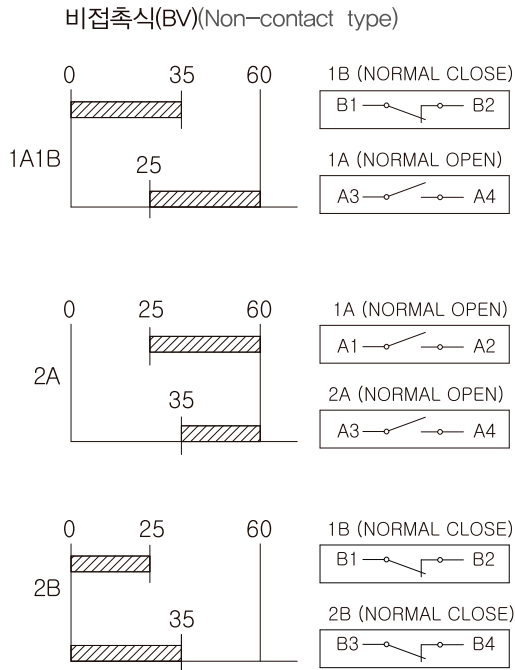

◆ 외형도(Outline Dimension)

제 품(Product)	사진(Photo)	외형도(Outline Dimension)
<p>WJL-BV</p> <p>- 비접촉 및 접촉식 (Non-contact & Contact type)</p> <p>- 1A1B, 2A, 2B</p> <p>- 2C/O</p> <p>- 중량(Mass) : 3,90Kg</p>		
<p>WJL-SBV</p> <p>- 접촉식 (Contact type)</p> <p>- 2C/O</p> <p>- 중량(Mass) : 3,28Kg</p>		

CONVEYOR BELT SAFETY SWITCH

◆ 제품선정(Product selection)

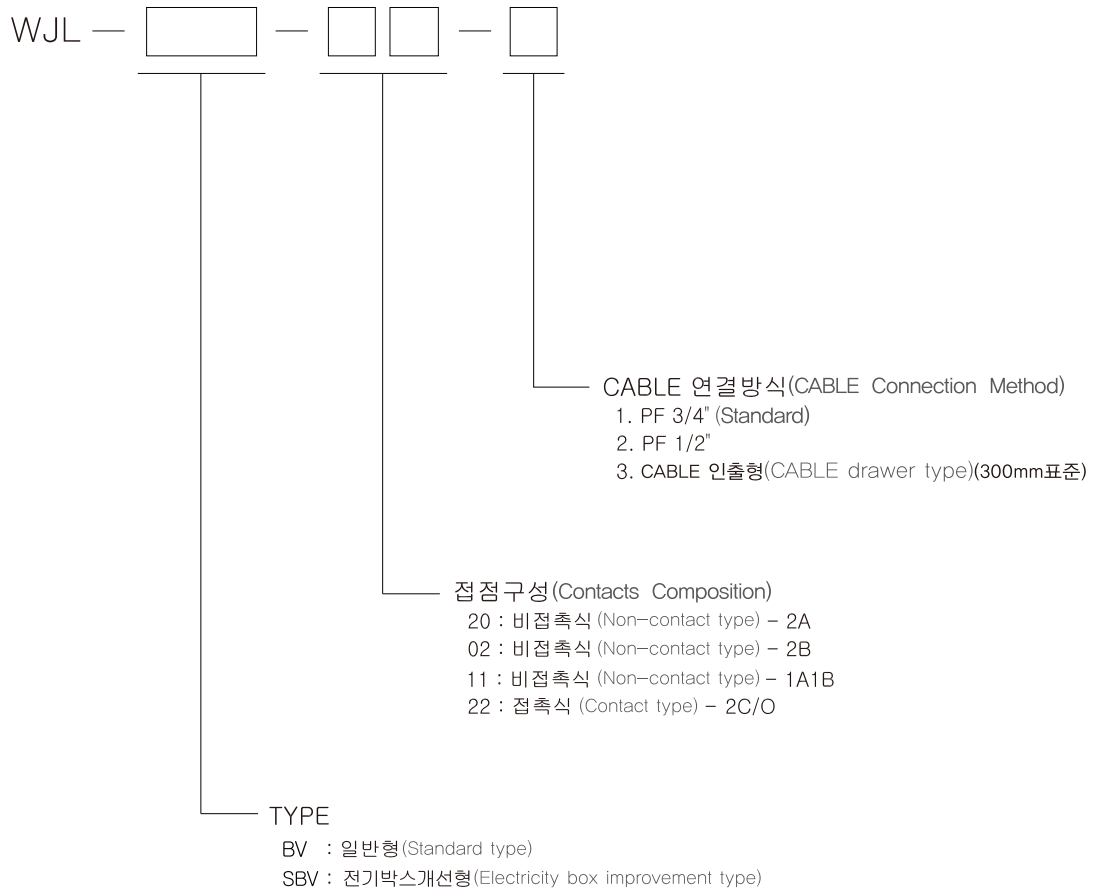

EXPLOSION PROOF BELT SWAY SWITCH
(EX tD A22 IP66 / EX d 2G/D II C IP66)



콘베이어벨트 작동중에 벨트가 한쪽으로 쓸림현상을 감지하는 장치입니다.

Belt Sway Switch is a device that perceives belt strain effect to one side when working conveyor belt.

◆ 특징(Features)

- 알루미늄 다이캐스팅 제품으로 방수,방진에 우수하다.
Is is aluminum die casting product and excellence in water proof and vibration proof
- 경보 및 제어를 동시에 할 수 있도록 2개 접점출력.
Output 2 contacts for alarm and control at the same time
- 접촉롤러가 라운드형태로 벨트 접촉이 원활하다.
Contact Roller is round type and smooths to contact belt
- 기술인증(Certification) : KTL, ATEX
- 보호등급(Protection CLASS) : KTL- EX tD A22 IP66 T85°C
ATEX-EX d 2G/D II C IP66



◆ 기본사양(Specification)

MODEL	WJL-BV-22EX
접점구성 (Contacts Composition)	SPDTx2(2C/O)
접점용량 (Contacts Capacity)	250VAC, 10A / 250VDC 0,3A
케이블 인입구 (Cable Entry)	PF3/4" 표준(Standard) (PF1/2)
적정온도 (Optimal Temperature)	-20°C ~ +80°C
IP등급(IP grade)	IP66
색 상 (Color)	하마톤 IPH 노랑(Hammertion IPH Yellow) (EX8816-YW002)

◆ 결선도(Connection)

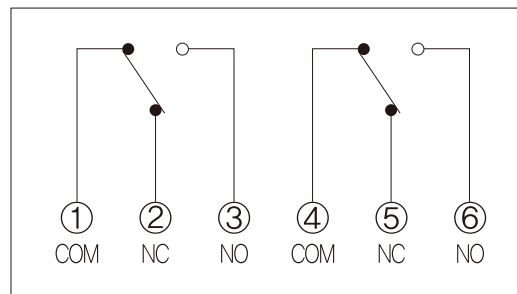

2C/O

CONVEYOR BELT SAFETY SWITCH

◆ 동작 각도(Operation Angle)

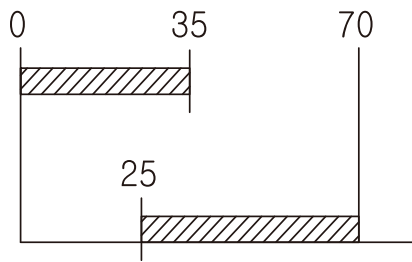

1B (NORMAL CLOSE)



1A (NORMAL OPEN)

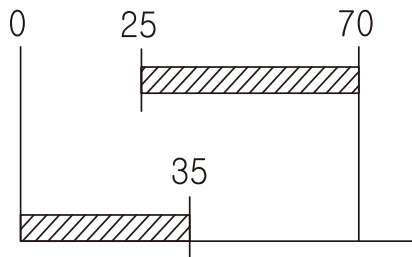
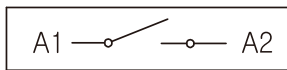

1A (NORMAL OPEN)

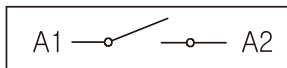

1B (NORMAL CLOSE)

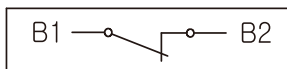

◆ 외형도 (Outline Dimension)

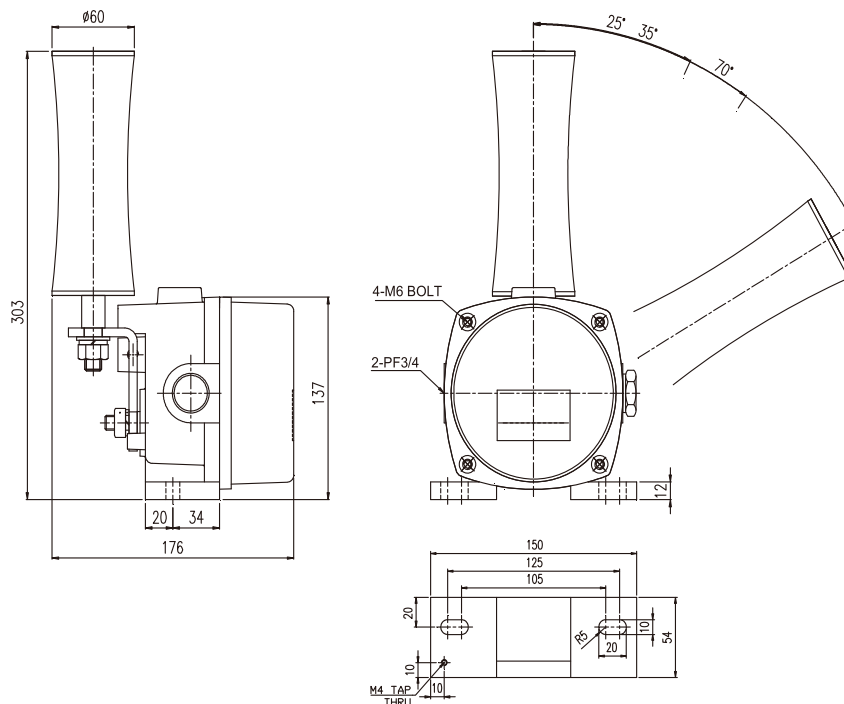

RIP SWITCH



◆ 제품설명(Product Description)

- BELT의 파손을 감지하여 2차고장을 방지하기위한 SWITCH 입니다.
It is switch to sense belt's break and prevent the second break,
- 본체가 일체형 알미늄 다이캐스팅 제품이며 내구성이 우수합니다.
The body is assembled type aluminum die casting product and excellence in durability.
- 방수 방진 기능이 우수하여 반영구적으로 사용할수 있습니다.
Water proof and vibration proof are excellent and it can be used as semipermanent.

◆ 외형도 (Outline Dimension)

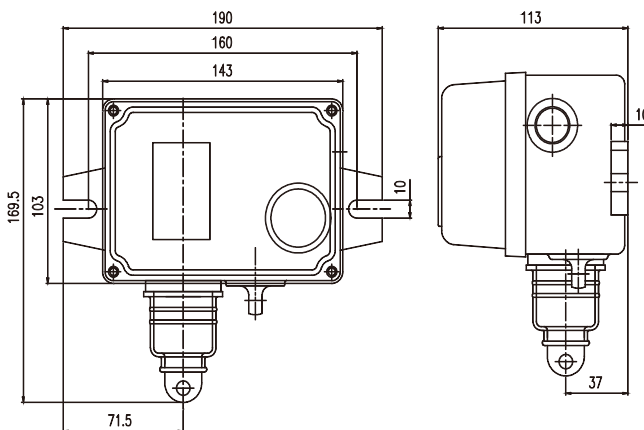

◆ 결선도(Connection)

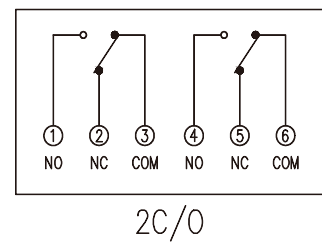

◆ 기본사양(Specification)

운전방식(Operation)	수동 복귀형(Manual Return Type)
접점구성 (Contacts Composition)	접촉방식(Contact method) : SPDTx2(2C/0)
접점용량 (Contacts Capacity)	250VAC, 15A / 250VDC, 0,3A
사용전원(Power)	110VAC / 250VAC
케이블 인입구 (Cable Entry)	PF1/2표준(Standard) (PF 3/4)
보호등급 Protection grade	IP66
적정온도 (Optimal Temperature)	-20°C ~ +80°C
색 상 (Color)	하마톤 IPH 노랑(Hammertion IPH Yellow) (EX8816-YW002)

CONVEYOR BELT SAFETY SWITCH

◆설치 예(Example)

- CARRIER부 설치예(Installation Example)

스위치 소켓과 벨트 상단 끝부분과의 거리는 103mm,
Distance between switch socket and top part of belt is 103mm.

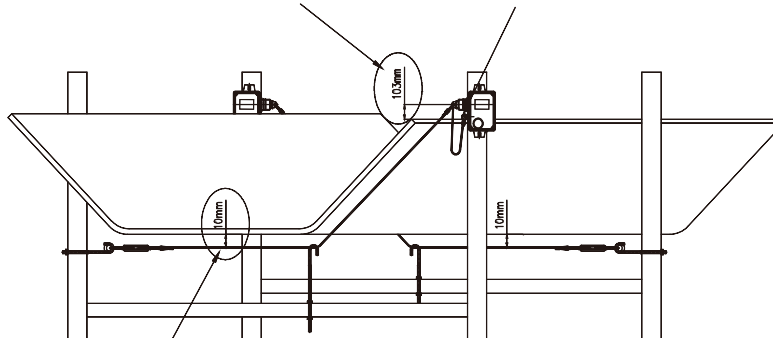

벨트 바닥과 와이어간 거리는 10mm를 유지 하시오.
Keep 10mm distance between belt bottom and wire.

소켓이 플러그에서 분리되면 와이어가 고리 밧줄에 연결되어 있어서 립 스위치를 다시 세팅하는 것을 쉽게 해준다. 이 고리밧줄은 대략 1m정도이며 필요에 따라 조정할 수 있다.
It is easy to reset rip switch because wire is connected to rope, once socket is detached from plug, this rope is about 1m and can be controlled according to your need.

- RETURN부 설치예(Installation Example)

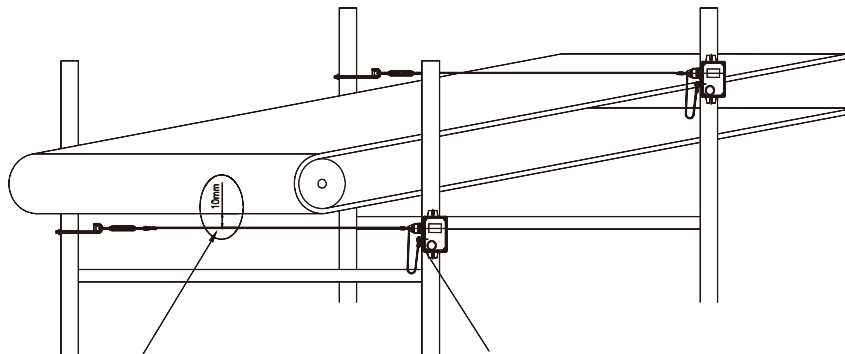

벨트 바닥과 와이어간 거리는 10mm를 유지 하시오.
Keep 10mm distance between belt bottom and wire.

소켓이 플러그에서 분리되면 와이어가 고리 밧줄에 연결되어 있어서 립 스위치를 다시 세팅하는 것을 쉽게 해준다. 이 고리밧줄은 대략 1m정도이며 필요에 따라 조정할 수 있다.
It is easy to reset rip switch because wire is connected to rope, once socket is detached from plug, this rope is about 1m and can be controlled according to your need.

◆ 제품선택 (Product selection)

WJL - RIP - 22 - EX -

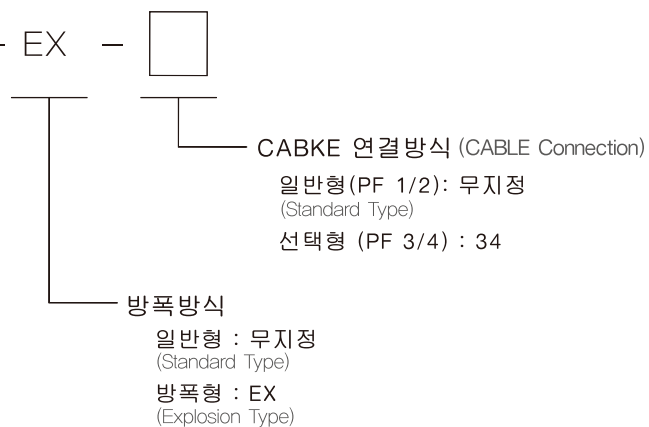

CABKE 연결방식 (CABLE Connection)

일반형 (PF 1/2): 무지정
(Standard Type)

선택형 (PF 3/4) : 34

방폭방식

일반형 : 무지정
(Standard Type)

방폭형 : EX
(Explosion Type)

SPEED SWITCH

CONVEYOR BELT의 속도를 검출하여 전기적, 기계적인 고장을 검출하는 장치이다.

Assembled Speed Switch is a device that checks CONVEYOR BELT Speed to check electrical and technical break.



센서분리형(Sensor Separation Type)

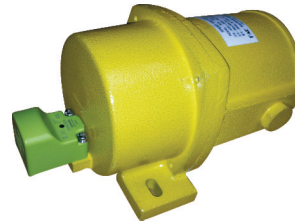

센서일체형(Sensor Assembled Type)

◆ 특징(Features)

- 디지털 제어 방식
Digital Control Type
- 동작속도 1~9999RPM 자유롭게 설정
Set operation Speed 1~9999RPM freely
- 비접촉방식 센서 적용
Apply Non-contact type sensor
- 스타트 업 타이머 내장되어 있음 (0~20SEC)
Built-in Start up Timer (0~20SEC)
- BY-PASS 기능이 있어 설비 중단없는 가동
Non-stop running set-up with BY-PASS function

◆ 사양(Specification)

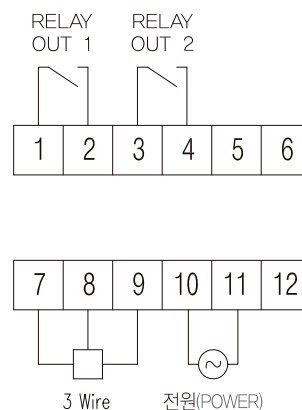
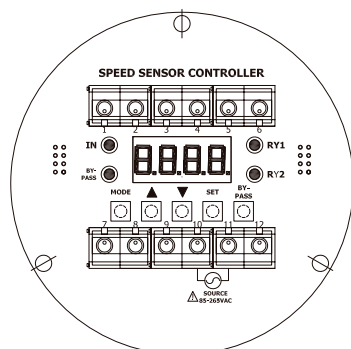

MODEL	WJL - SPD - 02	WJL - SPD - 03
전 원(POWER)	100~240VAC, 60Hz, FREE VOLTAGE	
입 력(INPUT)	BOX형 근접스위치 신호(Proximity switch signal 100Hz) 100Hz	
출 력(OUTPUT)	"2RELAY, 125VAC, 1A, 1ANALOG 출력(Output) : 0/4~20mA(OPTION)"	
스피드스위치 구조 (SPEED SWITCH STRUCTURE)	근접스위치를 몸체에 직접취부(일체형) Attach Proximity Switch directly to body (Assembled Type)	CABLE 1M BRACKET사용(분리형) Use CABLE 1M BRACKET(Separation Type)
CONTROL SPEED	1 ~ 9999Rpm	
케이블 인입구(Cable Entry)	PF 3/4"	

◆ 결선도(CONNECTION)

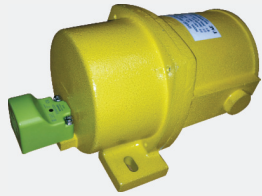
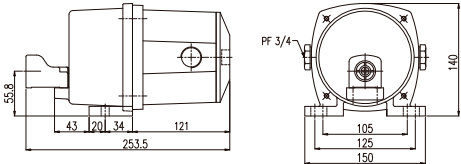

CONVEYOR BELT SAFETY SWITCH

◆ 외형도 (Outline Dimension)

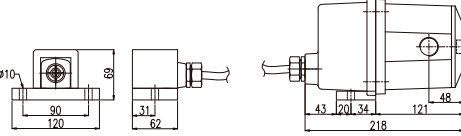
제품(Product) 사양(specifications)	사진 (Photo)	외형도 (Outline Dimension)
WJL-SPD-02 센서일체형 Sensor Assembled Type		
WJL-SPD-03 센서분리형 Sensor Separation Type		

◆ 제품선택(Product selection)

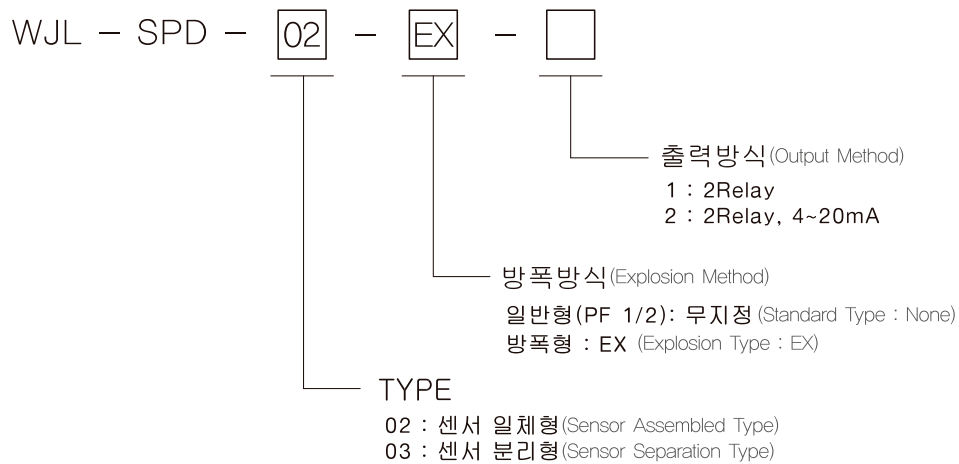

SPEED CONTROLLER & SENSOR

CONVEYOR BELT속도 검출을 CONTROL ROOM에서 제어 및 감시를 할 수 있다.
Speed Controller & Sensor can control and monitor speed of CONVEYOR BELT in CONTROL ROOM.



◆ 특징(Features)

- 디지털 제어 방식
Digital Control Type
- 동작속도 1~9999RPM 자유롭게 설정
Set Operation speed 1~9999RPM freely
- 비접촉 방식 근접스위치 적용
Apply Non-contact method Proximity Switch
- 스타트 업 타이머 내장되어 있음(0~20sec)
In-built Start up Timer(0~20sec)
- BY-PASS 기능이 있어 설비 중단없는 가동
Non-stop running set-up with BY-PASS function
- 근접스위치와 CONTROLLER와 최장 1.5Km 거리 가능
Distance between proximity switch and controller can be used up to 1.5Km.

◆ 사양(Specification)

TYPE	SPEED CONTROLLER			SPEED SENSOR	
사 양(MODEL)	WJ-SPC-01	WJ-SPC-02	WJ-SPC-03	WJ-SPP-01-30	WJ-SPP-02-30
전 원(POWER)	85 ~ 165VAC, 50 ~ 60Hz			10 ~ 65VDC	10 ~ 30VDC
입 력(INPUT)	AC/DC 2Wire, 3Wire PNP/NPN			2Wire, 2M	3Wire, 2M
출 력(OUTPUT)	2RELAY, 125VAC, 1A	2RELAY, 125VAC, 1A 1ANALOG Output: 0/4~20mA	2RELAY, 125VAC, 1A	15mm, NO	15mm, NPN NO
PULSE SPEED	1 ~ 9999RPM DISPLAY			≤100mA	≤200mA
크기(Dimension)	65Wx70Hx113D			M30 Chrome Plated	

* WJ-SPC-03 (Short Function Key Program)

◆ 결선도(Connection)

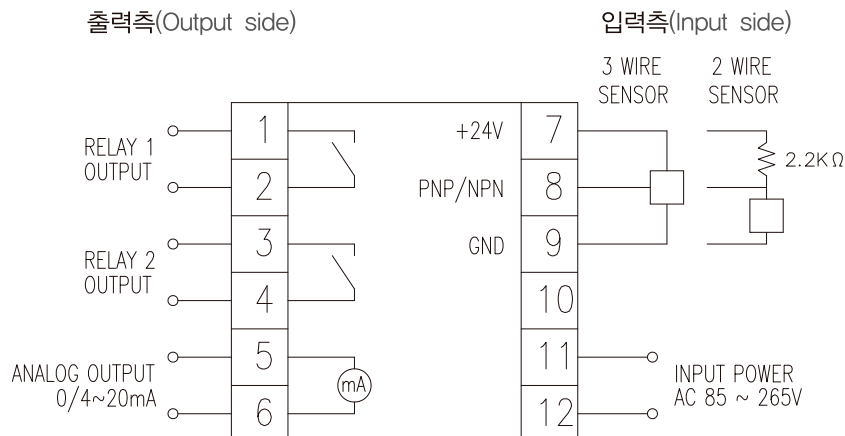

CONVEYOR BELT SAFETY SWITCH

◆ 외형도 (Outline Dimension)

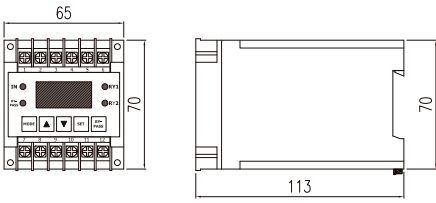
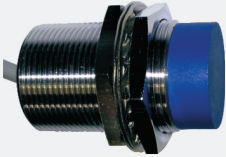
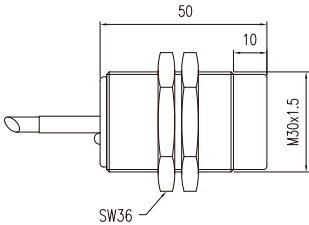
제품(Product) 사양(specifications)	사진(Photo)	외형도(Outline Dimension)
WJ-SPC-01		
WJ-SPC-02		
WJ-SPC-03		
WJ-SPP-01-30		
WJ-SPP-02-30		

◆ 제품선택(Product Selection)

WJL-SPC-

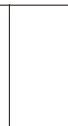

TYPE

01 : 2RELAY OUTPUT

02 : 2RELAY 0/4~20mA OUTPUT

03 : 2RELAY OUTPUT(Special order)

TILT SWITCH(CHUTE SWITCH) & CONTROLLER

호퍼내에 물체가 쌓여 막힘을 검출하는 장치이다.

Tilt Switch(Chute switch) & Controller is a device that checks piles in hopper.



◆ 특징(Features)

- 본체는 알루미늄 구조로 설계된 제품으로 기계적강도가 우수함.
Body is aluminum structure product and excellence in magnetic stress.
- STS CHAIN을 사용하여 내식성이 양호함.
Use STS CHAIN and Favorable corrosion resistance
- 동작각도 25° (±5°)
Operation angle 25° (±5°)
- 비수은 접점으로 반영구적 수명이다.
Non-mercury contact and semipermanent.

◆ 사양(Specification)

MODEL	WJL - DV - 02(고급형)	WJL - DV - 11(저가형)	WJL - DV - 12(FLOAT형)
동작각도(Operation angle)	25° (±5°)		
접점용량(Contacts Capacity)	250VAC / 125VDC, 3A		
접 점(Contacts)	SPST "B"		
재 질(Material)	AL+STS CHAIN	STS+STS CHAIN	
보호방식 (Protection Type)	IP66		
무 게(Mass)	1,92kg	1,86kg	1,42kg

CONTROLLER

- TILT SWITCH 작동여부를 TIME DELAY SWITCH(0.5~4초)를 사용하여 작동여부를 전달한다.
Use TIME DELAY SWITCH(0.5seconds ~ 4seconds) to convey movement of TILT SWITCH whether work or not.
- TILT SWITCH 접점(NC, NO)을 CONTROL SWITCH에서 출력접점(COM, NC, NO)을 사용할수 있다.
TILT SWITCH Contact(NC,NO) can be used in CONTROL SWITCH as output contact(COM, NC, NO).
- BOX 외부에 전원부, 출력부 LAMP를 사용하여 식별이 용이하다.
Out-situated power and output lamp help discrimination.



◆ 사양(Specification)

모델(MODEL)	WJL - DVC - 01
접점구성(CONTACT CAPACITY)	125VAC, 15A / 250VAC, 10A
형태(TYPE)	BOX형
케이블 인입구(CABLE ENTRY)	CONNECTOR #16 (PF1/2")
박스 재질(BOX MATERIAL)	ABS
무게(Mass)	1.1kg

◆ CONTROLLER 구조 및 사양 (Composition & Specifications)

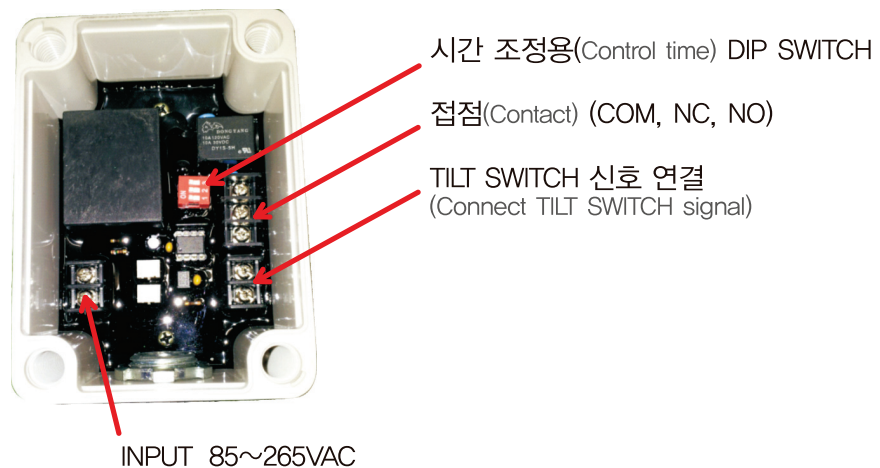

CONVEYOR BELT SAFETY SWITCH

FLOW SWITCH

CONVEYOR BELT 라인에 측정물의 유량 및 레벨을 측정하는 장치이다.

Flow Switch is a device that checks flow and level of measured objects in CONVEYOR BELT line.

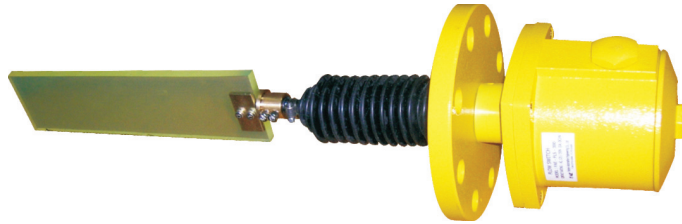

◆ 특징(Features)

- 방수, 방진 기능이 우수하다.
Excellence in water proof and vibration proof
- 본체는 일체형 구조로 설계된 알루미늄 제품으로 기계적강도가 우수하다.
Body is assembled structure aluminum product and excellence in strength of mechanical.
- PADDLE 재질은 현장조건에 따라 변경 사용이 가능하다.
Material of PADDLE can be changed depending on field condition.

◆ 제품선정(Product Selection)

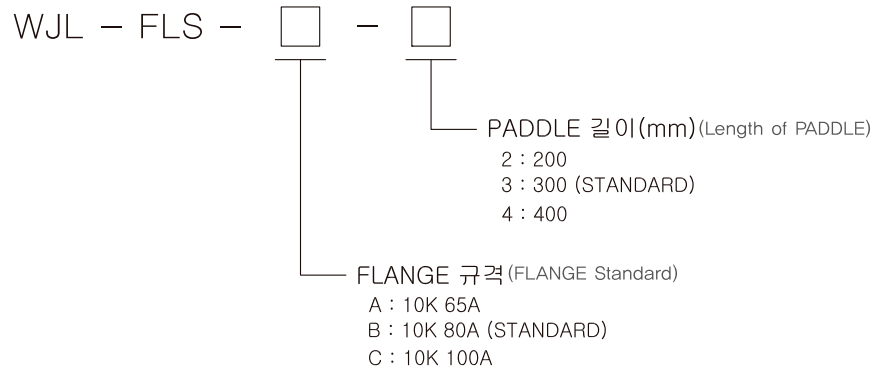

◆ 결선도(Connection)

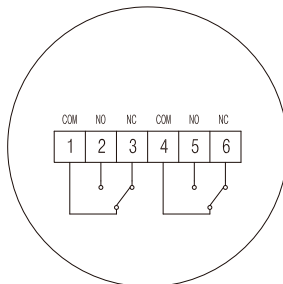

접점출력 (Contacts output)	2 C/O
본체재질 (Body material)	알루미늄 (Aluminum)
PADDLE 재질 (material)	URETHANE
무 게 (Mass)	6Kg
동작각도 (Operation angle)	15° (± 2°)
색 상 (Color)	EX8816 - YW002

◆ 외형도(Outline Dimension)

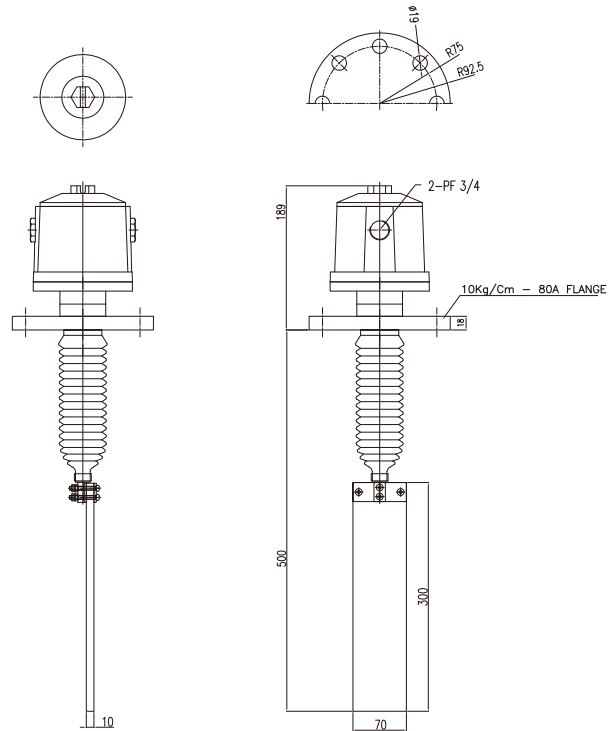

◆ 설치 예(Installation Example)

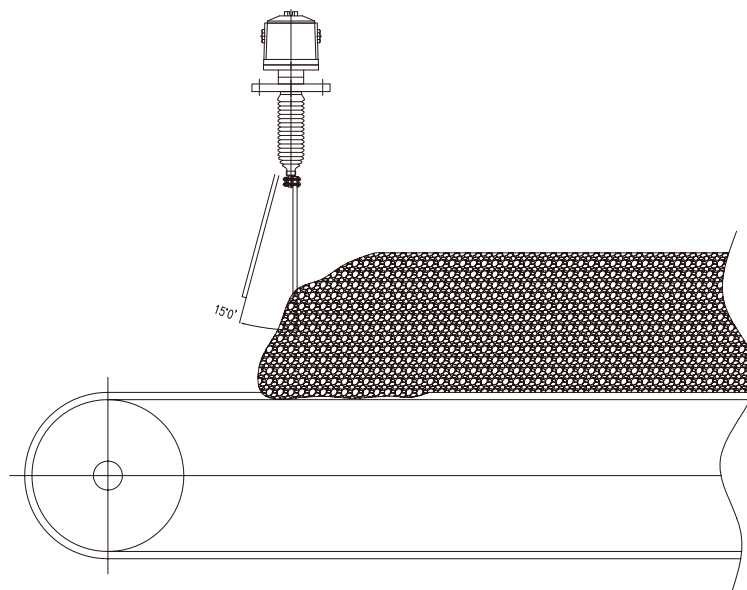

CONVEYOR BELT SAFETY SWITCH

ACCESSARY

◆ CONVEYOR BELT용 악세서리(Conveyor Belt Accessory)

– TURNBUCKLE (WJL-TR)

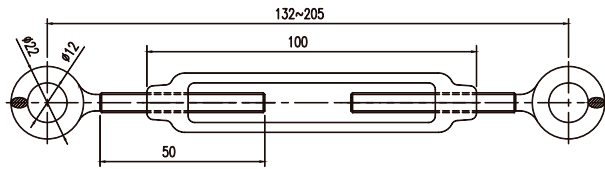

– WIRE RING (WJL-JR)

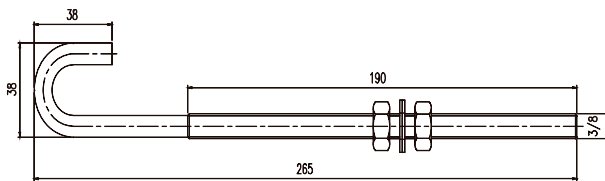

– WIRE RING(WJL-OR)

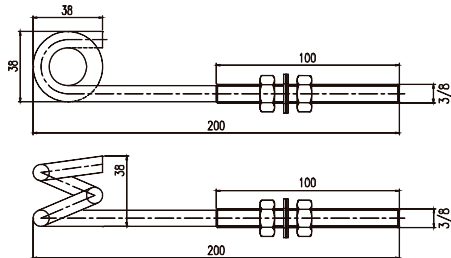

– WIRE CLIP(WJL-CR)

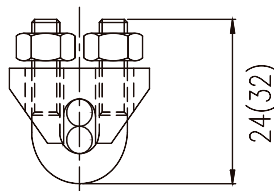

WJL - CR -

CLIP 선택(Selection)

1. Ø4
2. Ø6

◆ CONVEYOR BELT용 약세사리 (Conveyor Belt Accessory)

- WIRE (WJL-WR)

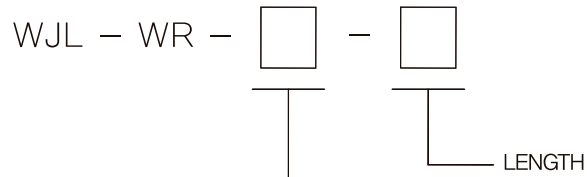
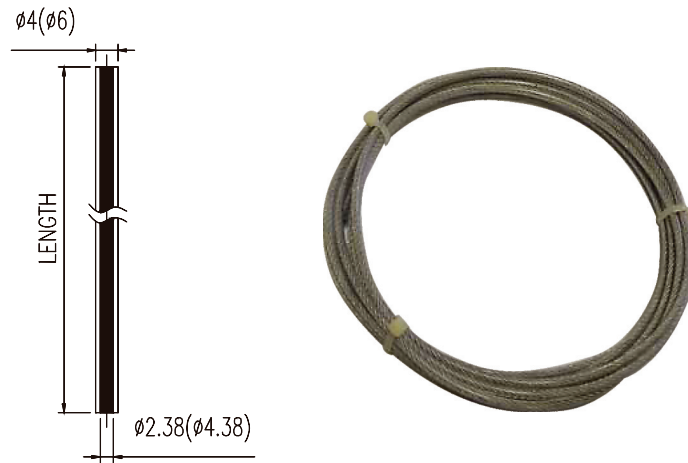

WIRE 선택 (WIRE Selection)

1. Ø4, 투명코팅 (Transparency coating)
2. Ø4, 적색코팅 (Red color coating)
3. Ø6, 투명코팅 (Transparency coating)
4. Ø6, 적색코팅 (Red color coating)

- EYE-BOLT(WJL-IR)

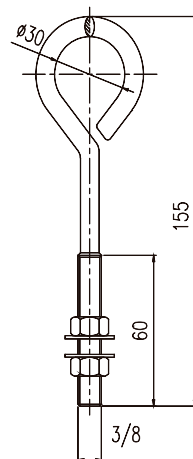

WARNING HORN WITH LIGHT 경고혼/경고등

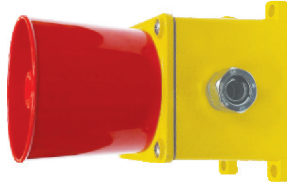

WJW-SQ30



WJW-SQD30

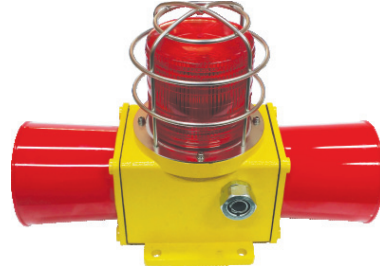

WJW-SQD32

◆ 특징(Features)

- 고휘도 LED 점등/점멸형 조절 가능
Product of high-brightness, flashing LED type.
- 내부스위치 및 볼륨으로 음색, 음량 조절 가능.
It can control timble and sound volume with internal switch and volume.
- 알루미늄 하우스형 선박, 중부하 제품으로 선박, 철강, 옥외플랜트 등 설치 가능.
Aluminum housing ship and heavy loading product that can set up vessel, steel and outdoor plant.
- 경고등과 혼이 일체형구조로 제작된 자립형 신호음 내장 제품
A warning light and horn is assembled and built in self-standing signal tone product.
- 방수, 방진(IP65)내식성 제품으로 옥외 설치 가능
It is water proof and vibration proof(IP65) corrosion resistance product so it is available outdoor set up.
- 외부 접촉으로부터 글로브를 보호하는 보호망 장착
Installed protection cage for preventing lens from outside impacting.

◆ 음색선택방법

(Method of selecting sound tone)

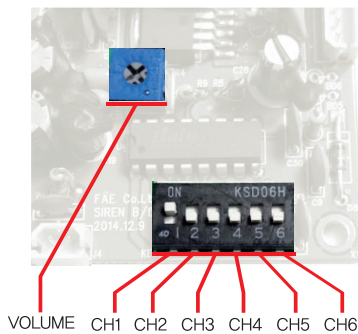

내부 스위치를 이용하여 음색을 선택합니다.
Sound tone can be selected by internal switch

- Ch1 : 긴급 (Urgency)
- Ch2 : 보안 (Security)
- Ch3 : 경보1 (Alarm1)
- Ch4 : 경보2 (Alarm2)
- Ch5 : 경보3 (Alarm3)
- Ch6 : 구급 (First aid)

◆ 광원조정방법

(Light source control method)

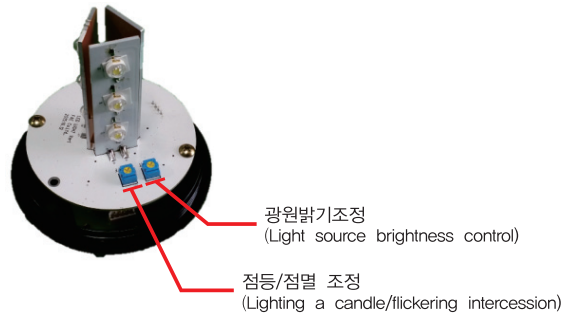

◆ 결선방법

(Wiring method)

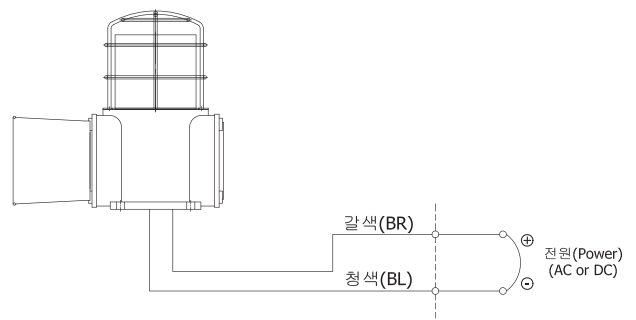

◆ 제품선정(Product selection)

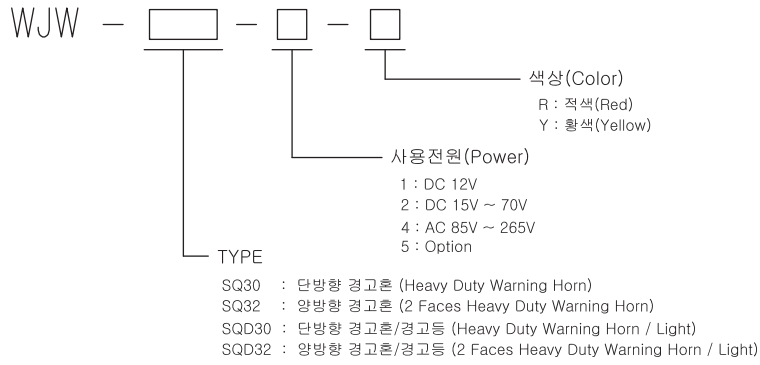

◆ 외형도(Outline Dimension)

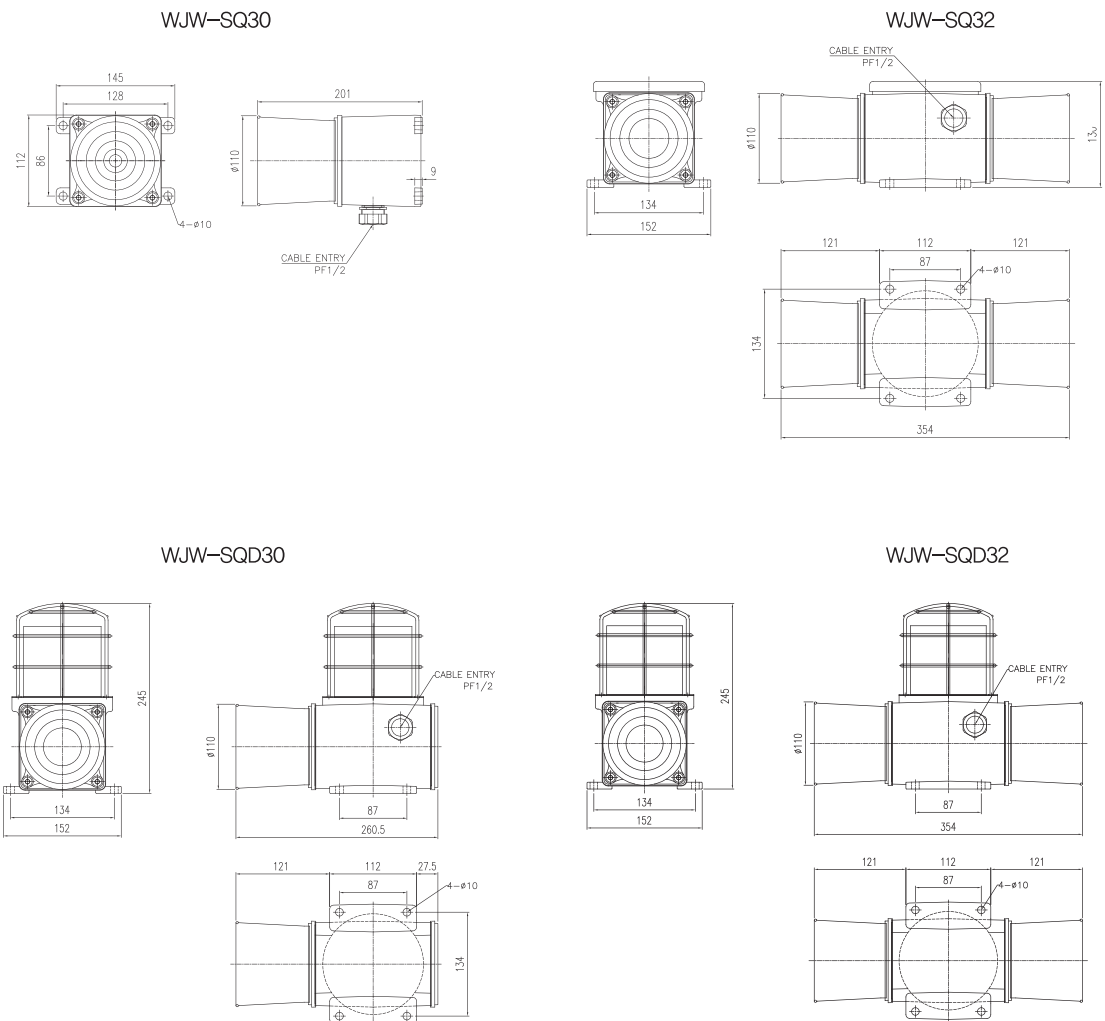



WJW-SQ30-10



WJW-SQD30-10



WJW-SD30-10

◆ 특징(Features)

- 고휘도 LED 점등/점멸형 조절 가능
Product of high-brightness, flashing LED type.
- 내부스위치 및 볼륨으로 음색, 음량 조절 가능.
It can control timble and sound volume with internal switch and volume.
- 알루미늄 하우징 선박, 중부하 제품으로 선박, 철강, 옥외플랜트 등 설치 가능.
Aluminum housing ship and heavy loading product that can set up vessel, steel and outdoor plant.
- 경고등과 혼이 일체형구조로 제작된 자립형 신호음 내장 제품
A warning light and horn is assembled and built in self-standing signal tone product.
- 방수, 방진(IP65)내식성 제품으로 옥외 설치 가능
It is water proof and vibration proof(IP65) corrosion resistance product so it is available outdoor set up.
- 외부 접촉으로부터 글로브를 보호하는 보호망 장착
Installed protection cage for preventing lens from outside impacting.

◆ 음색선택방법

(Method of selecting sound tone)

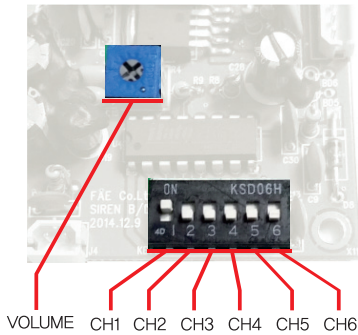

◆ 광원조정방법

(Light source control method)

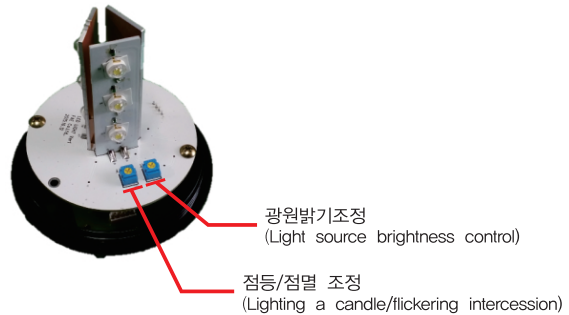

◆ 결선방법

(Wiring method)

내부 스위치를 이용하여 음색을 선택합니다.
Sound tone can be selected by internal switch

- Ch1 : 긴급 (Urgency)
- Ch2 : 보안 (Security)
- Ch3 : 경보1 (Alarm1)
- Ch4 : 경보2 (Alarm2)
- Ch5 : 경보3 (Alarm3)
- Ch6 : 구급 (First aid)

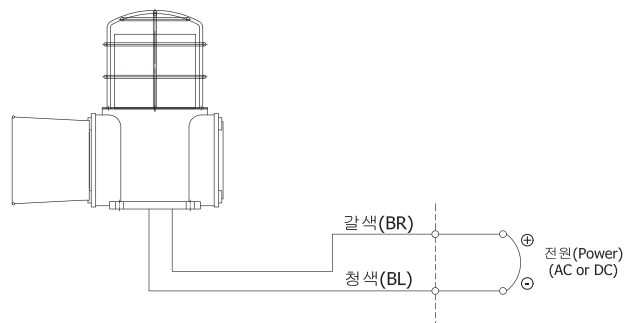

◆ 제품선정(Product selection)

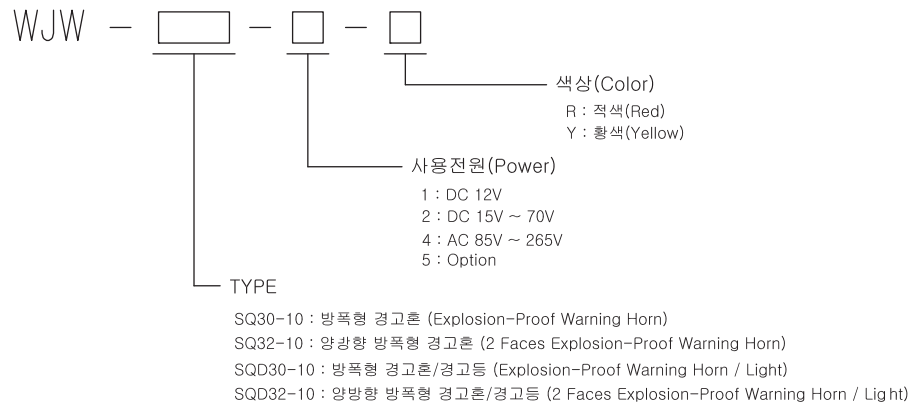

◆ 외형도(Outline Dimension)

WJW-SD30-10

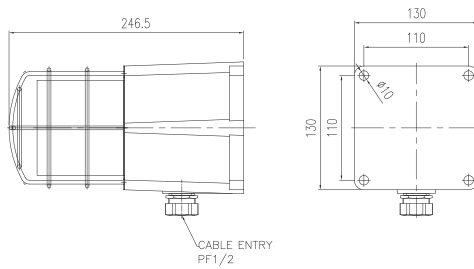

WJW-SQ30-10

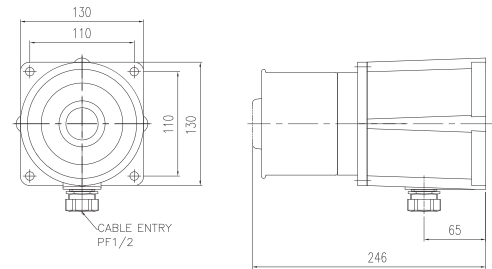

WJW-SQD30-10

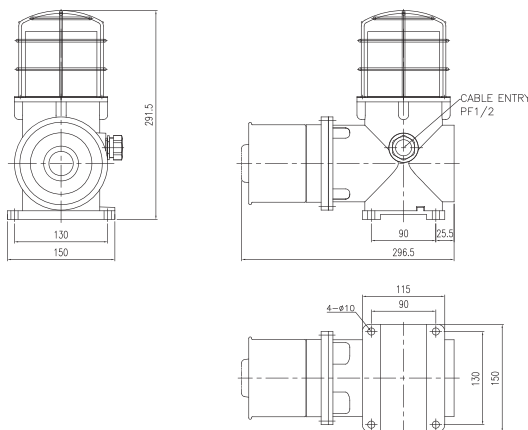

WJW-SQD32-10

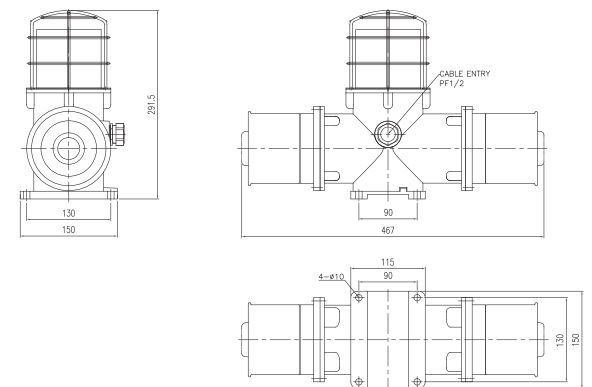



WJW-SDL80



WJW-SDL100



WJW-SD100



WJW-SD30

◆ 특징(Features)

- 고휘도 LED 점등/점멸형 조절가능.
Product of high-brightness, flashing LED type.
- 고휘도 LED 램프를 사용하여 시인성이 우수.
Gohwi uses LED lamp and poet is excellent.
- 반영구적인 광원 수명으로 경제성이 뛰어남.
Economic efficiency is excellent by semi-permanent light source life-time.

◆ 광원조정방법

(Light source control method)

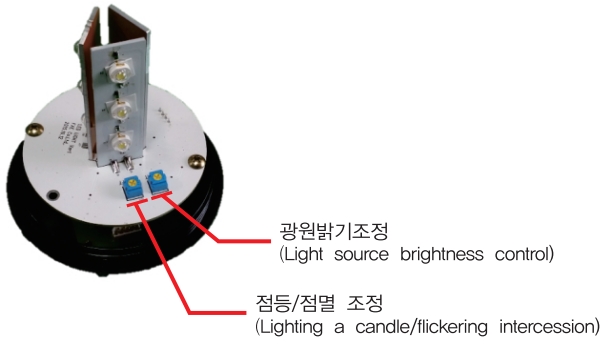

◆ 결선방법

(Wiring method)

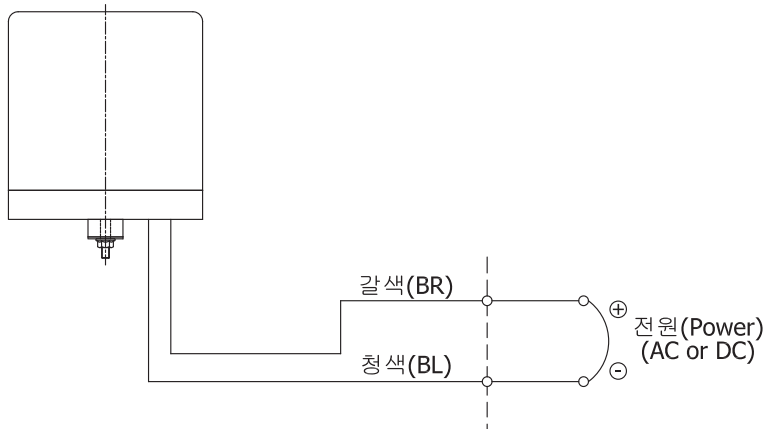

◆ 제품선정(Product selection)

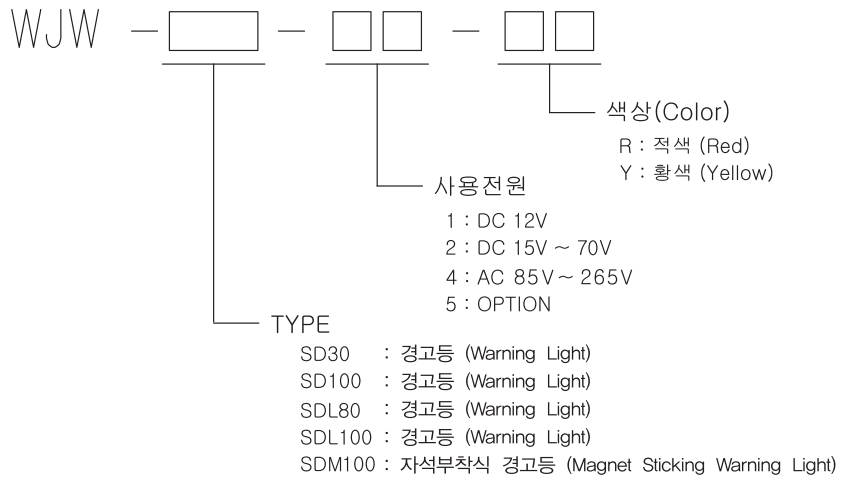

◆ 외형도(Outline Dimension)

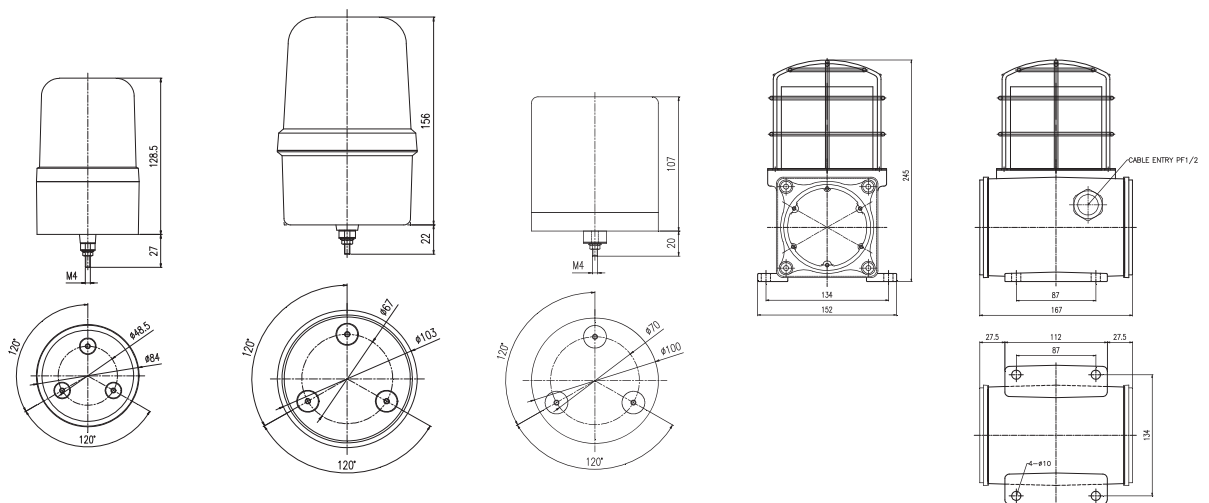

WJW-SDL80

WJW-SDL100

WJW-SD100

WJW-SD30

LIMIT SWITCH

WJL-L5

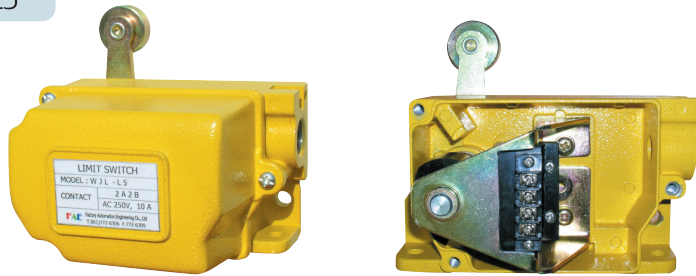

◆ 개요 및 특징(Introduction & Feature)

- 자동복귀형
Auto-Return Type
- Lever 작동시 Return Spring에 의해 작동 복귀되는 장치입니다.
This is a device that lever is Automatically returned by return spring,
- IP65

◆ 표준사양(Standard Specification)

MODEL	WJL - L5
접점구성 (Contacts Composition)	비접촉 방식(Non-Contacting) : SPSTx2(2A,1A1B,2B) 접촉방식(Contact method) : SPDTx2(2C/O)
접점용량 (Contacts Capacity)	비접촉 방식(Non-Contacting) : 250VAC, 1A / 200VDC, 1.5A 접촉방식(Contact method) : 250VAC, 10A / 250VDC, 0.3A
케이블 인입구 (Cable Entry)	PF1/2"
사용주위온도 (Optimal Temperature)	-20°C ~ +80°C
색 상 (Color)	하마톤 IPH 노랑(Hammertion IPH Yellow) (EX8816-YW002)

◆ 제품선정 (Product selection)

WJL- L5 - 2 2 - 0 1

- 01 : Short Lever
- 02 : Long Lever
- 접점구성
(Contacts Composition)
- L5 - 일반형
STANDARD Type
- L5H - 고온형(80°C)
High Temp.Type(80°C)

접점구성 (Contacts Composition)

비접촉방식 : 11⇒1A1B
(Non-Contact Method) 20⇒2A
02⇒2B

접촉방식 : 22⇒2C/O
(Contact type)

◆ 외형도(Outline Dimension)

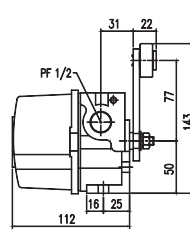
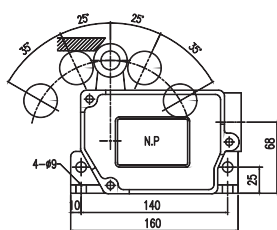

(Short Lever)

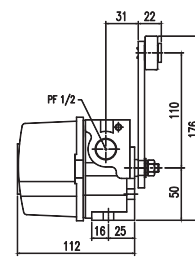

(Long Lever)

WJL-L6



WJL-PI



◆ 개요 및 특징(Introduction & Feature)

- 자동복귀형
Manual Return Type
- Lever 작동시 Return Spring에 의해 작동 복귀되는 장치입니다.
This is a device that lever is held on at operating position by interlock function.
- IP65

◆ 표준사양(Standard Specification)

MODEL	WJL-L6 / WJL - PI
접점구성 (Contacts Composition)	비접촉 방식(Non-Contacting) : SPSTx2(2A,1A1B,2B) 접촉방식(Contact method) : SPDTx2(2C/O)
접점용량 (Contacts Capacity)	비접촉 방식(Non-Contacting) : 250VAC, 1A / 200VDC, 1.5A 접촉방식(Contact method) : 250VAC, 10A / 250VDC, 0.3A
케이블 인입구 (Cable Entry)	PF1/2"
사용주위온도 (Optimal Temperature)	-20°C ~ +80°C
색 상 (Color)	하마톤 IPH 노랑(Hammerton IPH Yellow) (EX8816-YW002)

◆ 제품선정 (Order Information)

WJL - L6 - 2 2

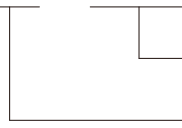

접점구성
(Contacts Composition)

L6 - 일반형
STANDARD Type
L6H - 고온형 (80°C)
High Temp.Type(80°C)

PI - 일반형
STANDARD Type
PIH - 고온형 (80°C)
High Temp.Type(80°C)

접점구성
(Contacts Composition)

비접촉방식 : 11⇒1A1B
(Non-Contact Method) 20⇒2A
02⇒2B

접촉 방식 : 22⇒2C/O
(Contact type)

◆ 외형도(Outline Dimension)

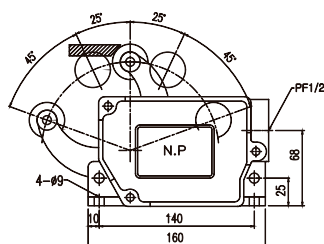

(WJL-L6)

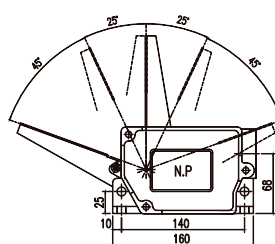

(WJL-PI)

LIMIT SWITCH

Weight Type(WJL -G)

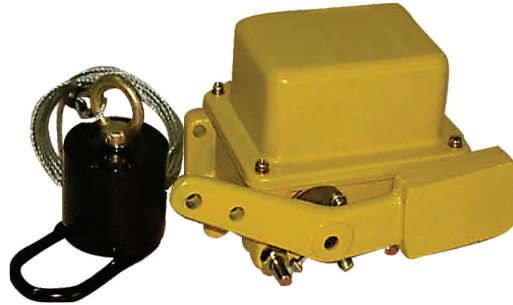

◆ 개요 및 특징(Introduction & Feature)

- Limit Switch에 매단 추에 의해 작동되는 권상기구의 상한제어용 장치입니다.
This is a hoist device, suspended from limit switch.

◆ 표준사양(Standard Specification)

- Usage : Over Running Prevention
- Point of Contact : 2C/O (2A2B)
- Voltage : 250VAC, 10A / 14VDC, 15A
- Painting Color : Hamaton IPH Yellow

◆ 외형도(Outline Dimension)

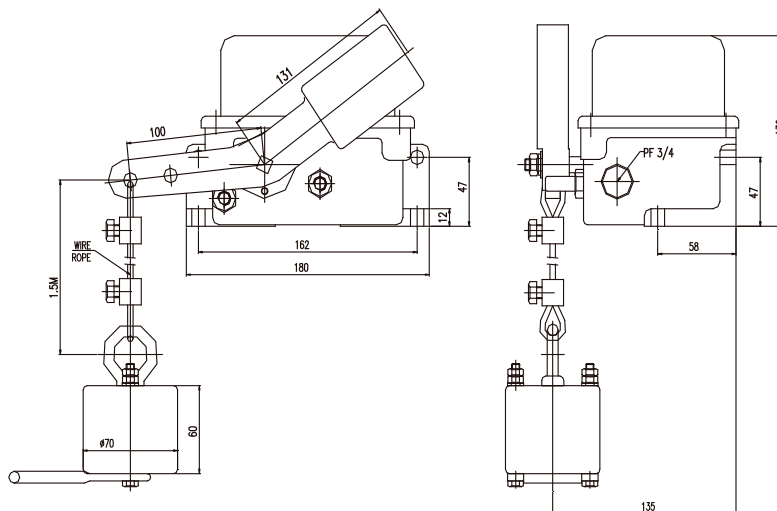

Weight Type(WJL -LA)

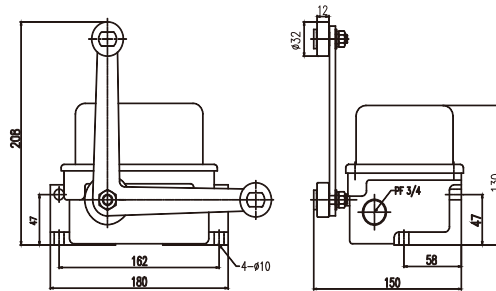

◆ 개요 및 특징(Introduction & Feature)

- 수동복귀형
Manual Return Type
- Lever 작동시 Inter lock에 의해 작동위치에 Holding되는 장치입니다.
This is a device that lever is held on at operating position by interlock function.

◆ 표준사양(Standard Specification)

- Usage : Limited to traversable motion
- Point of Contact : 2C/O (2A2B)
- Voltage : 250VAC, 10A / 14VDC, 15A
- Painting Color : Hamaton IPH Yellow

Lever Type(WJL -LB)

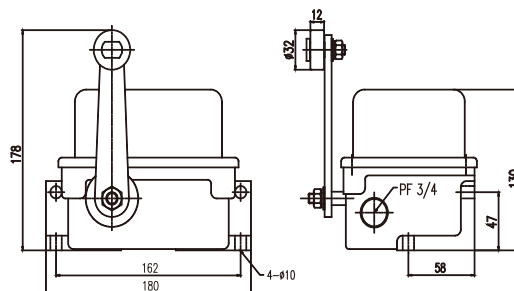

◆ 개요 및 특징(Introduction & Feature)

- 자동복귀형
Auto-Return Type
- Lever 작동시 Return Spring에 의해 작동되는 장치입니다.
This is a device that lever is automatically started by return spring.

◆ 표준사양(Standard Specification)

- Usage : Limited to traversable motion.
- Point of Contact : 2C/O (2A2B)
- Voltage : 250VAC, 10A / 14VDC, 15A
- Painting Color : Hamaton IPH Yellow

LIMIT SWITCH

Worm Gear Type(WJL-W2, W4)

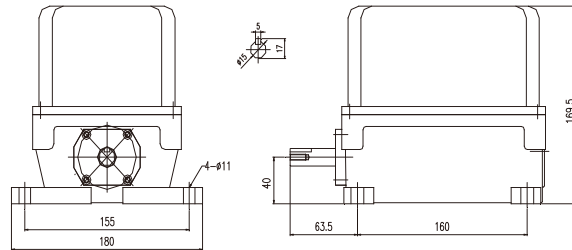

◆ 표준사양(Standard Specification)

- Usage : Over Running Prevention
- Point of Contact : 2C/O (2A2B) / 4C/O (4A4B)
- Voltage : 250VAC, 10A / 14VDC, 15A
- Painting Color : Hamaton IPH Yellow

TYPE	Gear Ratio	Max. Rev	Contact
WJL-21	1/100	80	2C/O
WJL-22	1/50	40	2C/O
WJL-23	1/25	20	2C/O
WJL-41	1/100	80	4C/O
WJL-42	1/50	40	4C/O
WJL-43	1/25	20	4C/O

Worm Gear Type(WJL-W8)

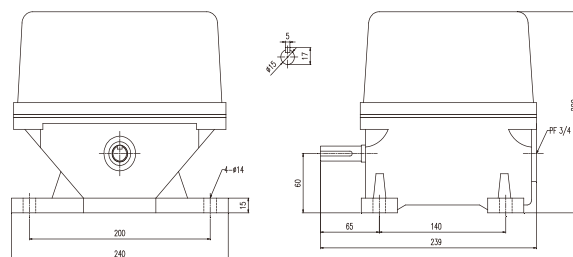

◆ 표준사양(Standard Specification)

- Usage : Over Running Prevention
- Point of Contact : 8C/O (8A8B)
- Voltage : 250VAC, 10A / 14VDC, 15A
- Painting Color : Hamaton IPH Yellow

TYPE	Gear Ratio	Max. Rev	Contact
WJL-81	1/100	80	8C/O
WJL-82	1/50	40	8C/O
WJL-83	1/25	20	8C/O

MAGNET SWITCH

◆ 제품설명(Product Selection)

- 사양 : WJ-MS10-1819P-A (NO) Two Position
- WJ-MS10-1819P-B (NC) Two Position
- WJ-MS10-1819A-A (NO) Automatic Reset
- WJ-MS10-1819A-B (NC) Automatic Reset



◆ 제품 사양 MODEL(Product Specification)

사용전압 (Voltage)	240VAC 2,5A, 110VAC 0,5A
사용전류 (Current)	Max. 3A
용량 (Capacity)	Max. 120VA / W
주파수 (Frequency)	< 300Hz
사용온도 (Temperature)	-20°C ~ +70°C
최대작동 거리 (Detection Distance)	60mm
기계적 수명 (Mechanical Life)	10,000,000Time
전기적 수명 (Electrical Life)	1,000,000Time
색상 (color)	Gold color

◆ 적용(Application)

- CGL LOOPER, 이동대차, 크레인
- CGL LOOPER, TRANSFER CAR, CRANE

◆ 외형도(Outline Dimension)

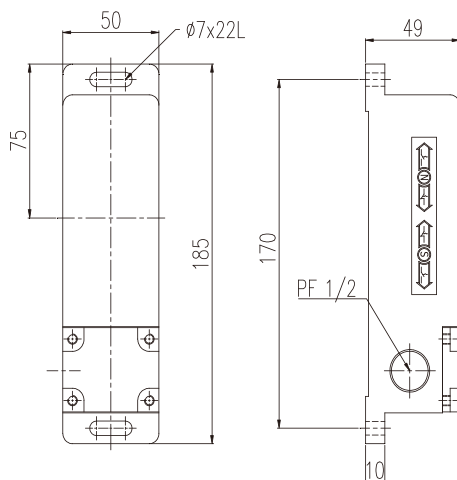

◆ 결선도(Connection)

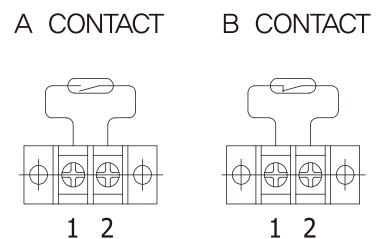

MAGNET SWITCH

MAGNET

◆ 외형도(Outline Dimension)

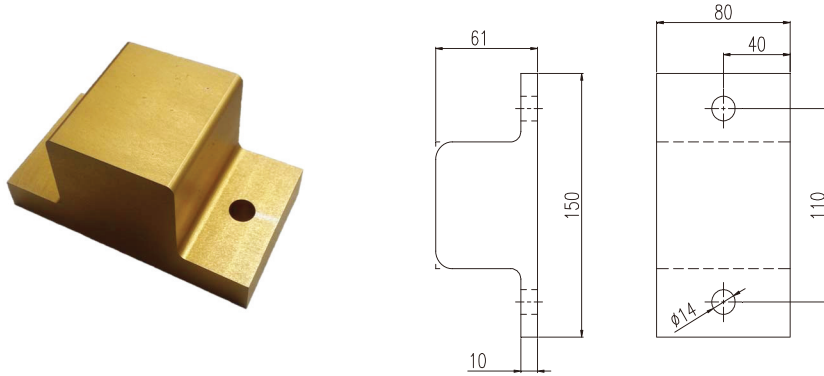

- 사양(Specification) : WJ-MG36-N (GOLD COLOR)
WJ-MG36-S (WHITE COLOR)
- 검출거리(Detection distance) : 60mm
- 사용온도(Temperature) : -20°C~+70°C
- 재 질(Material) : AL

◆ SWITCH 동작예(Switch Movements)

- P-Type 동작원리(P-Type Actuation Principle)

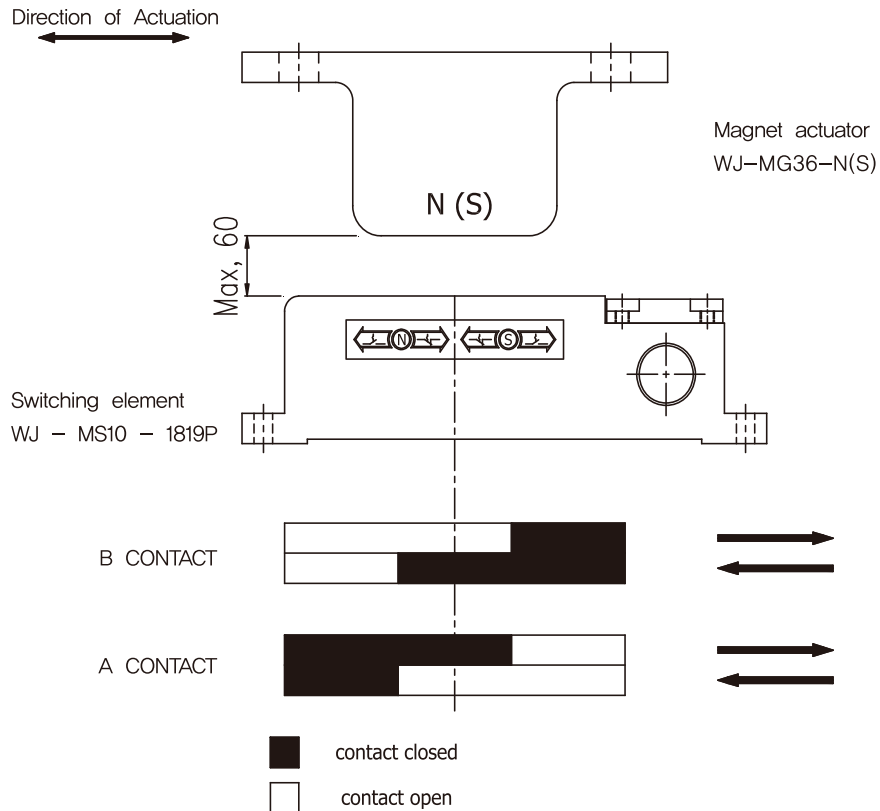

◆ SWITCH 동작예(Switch Movements)

- A-Type 동작원리(A-Type Actuation Principle)

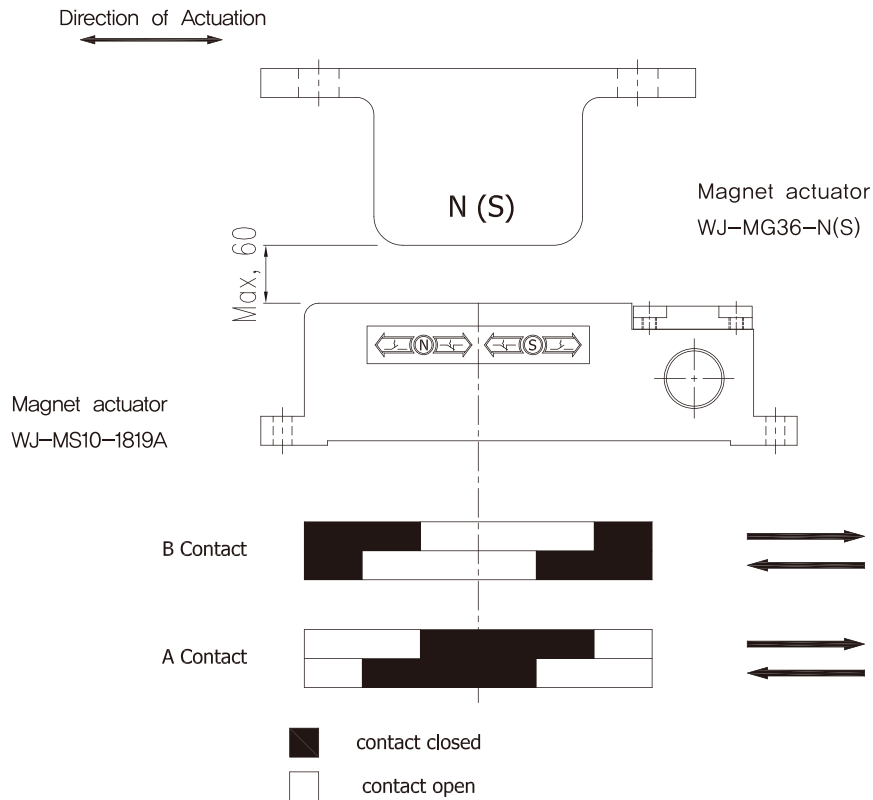

- P-Type 동작범위
(P-Type Action Extent)

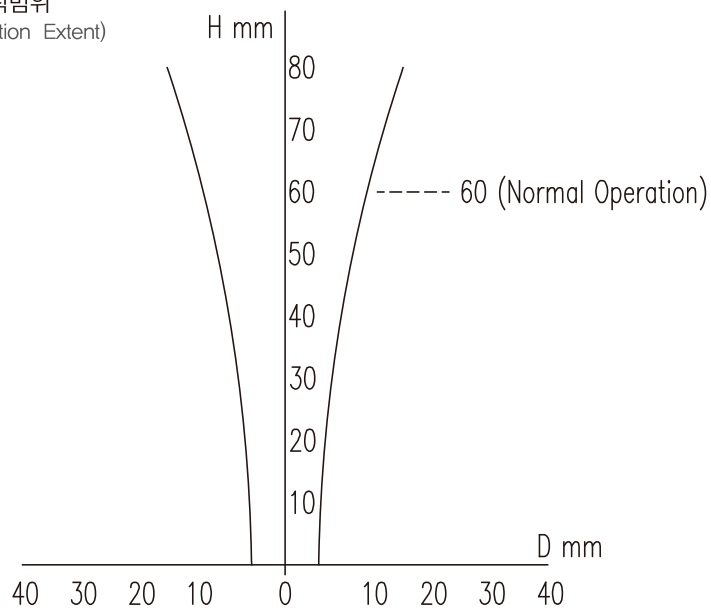

MAGNET SWITCH

MAGNET SWITCH

◆ 제품설명(Product Explanation)

- 사양 : WJ-MS4-H (Automatic Reset)
(Specification : WJ-MS4-H (Automatic Reset))

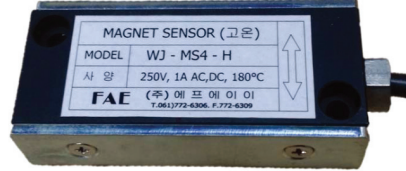

◆ 제품 사양(Product Specification)

사용전압 (Voltage)	240VAC 1A, 110VAC 0.5A
사용전류 (Current)	Max, 1.5A
용량 (Capacity)	Max, 120VA / W
주파수 (Frequency)	< 300Hz
사용온도 (Temperature)	-20°C ~ +180°C
최대작동 거리 (Maximum distance)	35mm (Max, 55mm)
기계적 수명 (Mechanical Life)	10,000,000 Time
전기적 수명 (Electrical Life)	1,000,000 Time

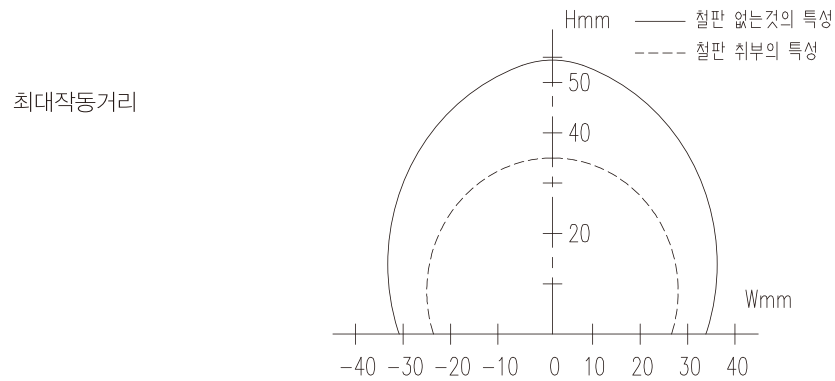

◆ 적 용(Application)

- 코크스, 소결, 고로, 제강, 연주, 열연, 냉연, Conveyor등에 사용
(Coke, Sinter, Steelmaking, Performance, Cold mill, Hot-rolled, To Conveyor use.)

◆ 외형도(Outline Dimension)

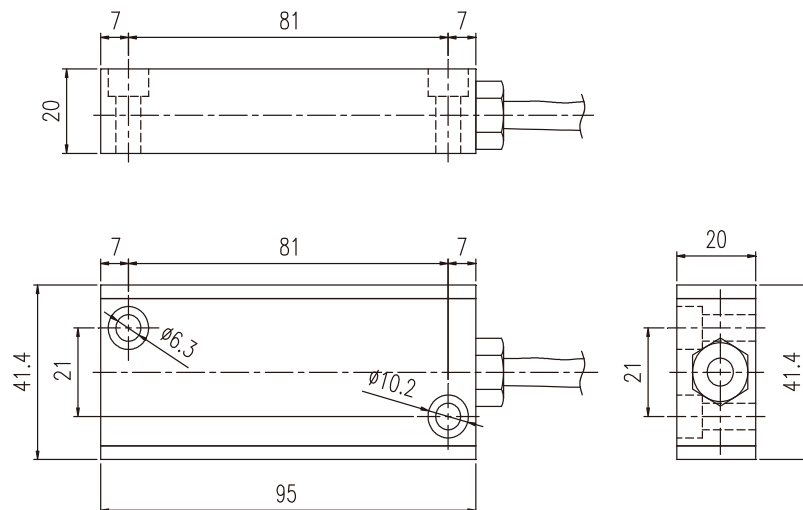

MAGNET

◆ 외형도(Outline Dimension)

- 사양 : WJ-MG4-H
(Specification : WJ-MG4-H)

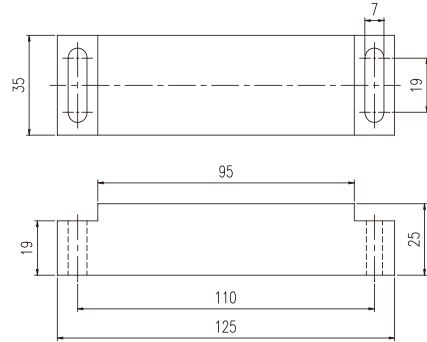

- 검출거리(Detection distance) : 55mm
- 사용온도(Temperature) : -20°C ~ +180°C
- 재질(Material) : AL

◆ SWITCH 동작예(Switch Movements)

(Direction of actuation)

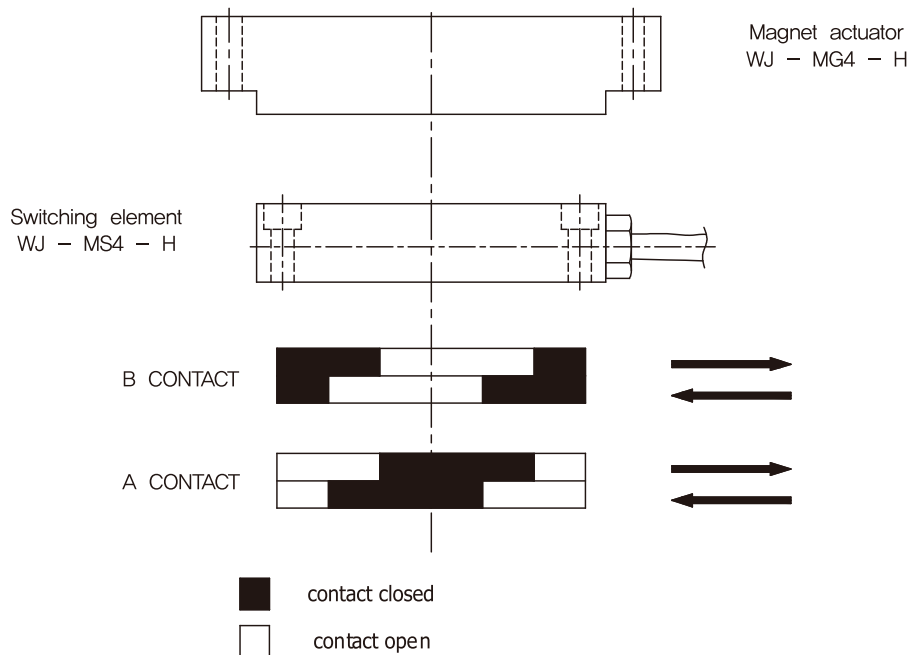

Factory Automation Engineering Co.,Ltd

Make Your Dream with FAE Company



제조원

FAE (주)에프에이이
Factory Automation Engineering

대리점

전남 광양시 남산3길 19(광영동)

TEL : 061-772-6306

FAX : 061-772-6309

www.pro-fae.co.kr

*본 카탈로그에 기재된 사양 · 외형치수 등은 제품의 개선에 의하여 예고없이 개선될 수 있습니다.